

Item	Caixa Caja Box	Qtd Ctd Qty	Descrição   Descripción   Description	Medidas (mm)   Dimensions (mm)   Size (measure- ments) (mm)
01	1/3	01	Rodapé Frontal   Rodapié Frontal   Front baseboard	1776x120x12
02	1/3	01	Travessa do rodapé   Carril pie   Baseboard crosspiece	415x120x12
03	1/3	01	Rodapé Traseiro   Rodapié trasero   Rear baseboard	1776x120x12
04	1/3	01	Base   Base   Base	1776x445x12
05	2/3	01	Divisão esquerda   División izquierda   Left division	1518x445x12
06	2/3	01	Tampo das Gavetas   Tapa del cajón   Drawer Top	584x400x12
07	2/3	01	Divisão direita   División derecha   Right division	1880x445x12
08	1/3	01	Ripa do Maleiro   Listón del Armario de Equipaje   Clapboard luggage locker	350x73x12
09	2/3	01	Chão do Maleiro   Piso del Armario de Equipaje   Floor of the Maleiro	1180x445x12
10	1/3	03	Prateleira   Estante   Shelf	584x350x12
11	1/3	01	Lateral esquerda   Lateral izquierda   Left side	2100x445x12
12	1/3	01	Prateleira do varão   Estante hombre   Man shelf	584x300x12
13	1/3	01	Tampo Superior   Arriba   Top	1776x445x12
14	1/3	01	Lateral direita   Lateral derecha   Right side	2100x445x12
15	1/3	01	Chapéu   Sombrero   Hat	1798x80x15
16	3/3	03	Fundo   Fondo   Bottom	1904x598x3
17	3/3	06	Porta   Puerta   Door	1888x295x15
18	1/3	02	Frente de gaveta   Frente de cajón   Front of drawer	526x145x12
19	1/3	04	Lado de gaveta   Lado del cajón   Side of drawer	350x100x12
20	1/3	02	Fundo de gaveta recortado   Fondo del cajón recortado   Cropped drawer bottom	508x367x3
21	1/3	02	Ripa de trás   Malla detrás   Rear lath	509x100x12



Ind. e Com. de Móveis Henn  
Mondai - SC - Brasil

+55 49 3674.3500

@moveishenn  
www.henn.com.br

## INSTRUÇÕES DE MONTAGEM

INSTRUCCIONES DE MONTAJE  
ASSEMBLY INSTRUCTIONS

ROUPEIRO 06 PORTAS 02 GAVETAS | ARMARIO 06 PUERTAS 2 CAJONES | WARDROBE 06 DOORS 2 DRAWERS

- B75-124 Damasco HP/Areia HP
- B75-127 Nature/Off White
- B75-130 Castanho HP

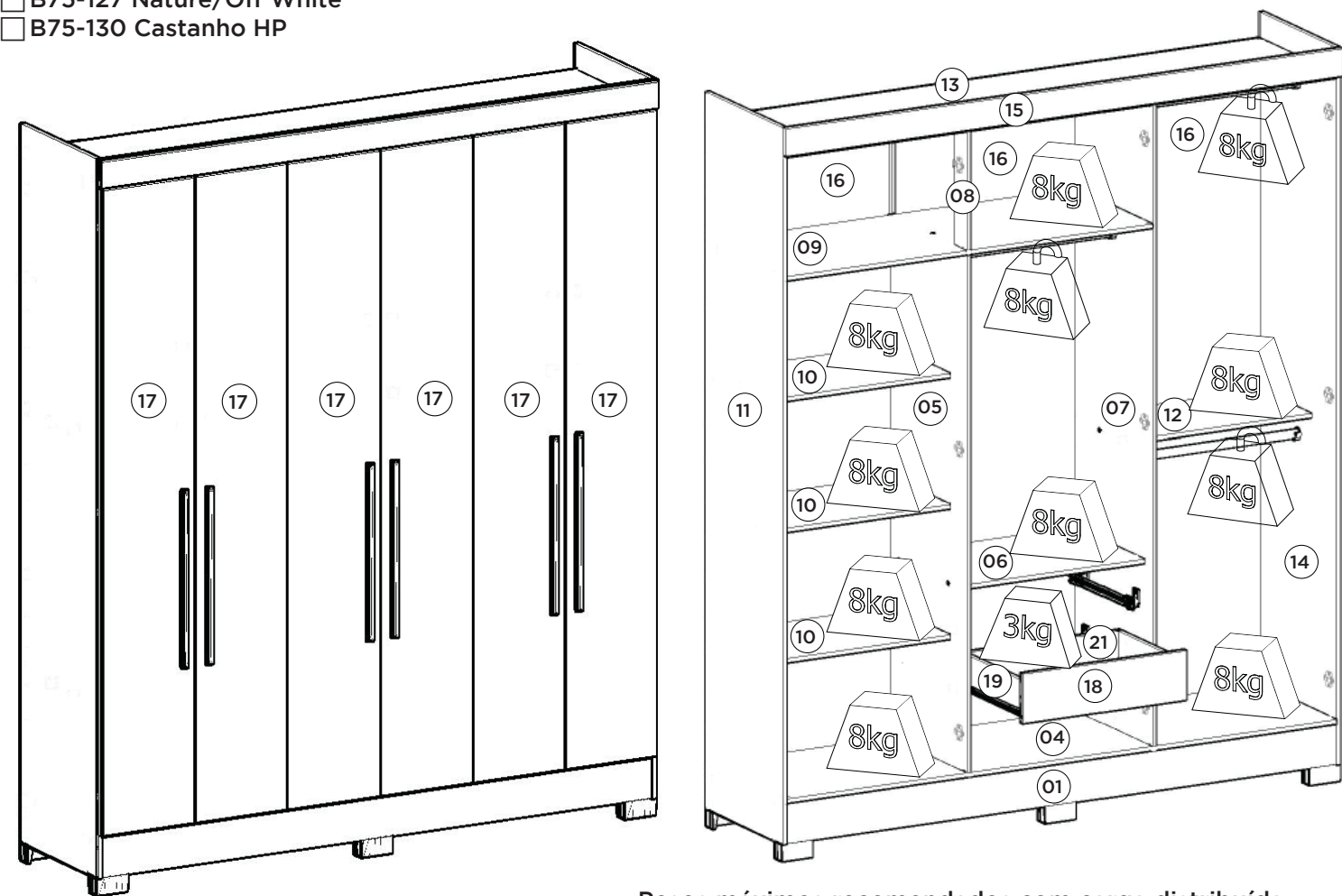

Pesos máximos recomendados com carga distribuída  
Peso máximo recomendado con la carga distribuida  
Recommended maximum weights with evenly distributed.

### Ferragens | Herrajes | Hardware

<b>A</b> 12x  Parafuso 4,0x22mm FLA. Tornillo 4,0x22mm FLA. Screw 4,0x22mm FLA.	<b>B</b> 04x  Parafuso 4,5x50mm CHT. Tornillo 4,5x50mm CHT. Screw 4,5x50mm CHT.	<b>C</b> 30x  Parafuso 3,5x40mm CHT. Tornillo 3,5x40mm CHT. Screw 3,5x40mm CHT.	<b>D</b> 18x  Parafuso 3,5x25mm FLA. Tornillo 3,5x25mm FLA. Screw 3,5x25mm FLA.	<b>E</b> 96x  Parafuso 3,5x12mm FLA. Tornillo 3,5x12mm FLA. Screw 3,5x12mm FLA.	<b>F</b> 16x  Parafuso 3,5x12mm CHT. Tornillo 3,5x12mm CHT. Screw 3,5x12mm CHT.
<b>G</b> 18x  Parafuso 3,0x16mm CHT. Tornillo 3,0x16mm CHT. Screw 3,0x16mm CHT.	<b>H</b> 66x  Cavilha 5x25mm Cinta 5x25mm Dowel 5x25mm	<b>I</b> 04x  Prego 12x12mm Anelado Clavo 12x12mm Anillado Ringed Nails 12x12mm	<b>J</b> 117x  Prego 10x10mm Clavo 10x10mm Nail 10x10mm	<b>K</b> 25x  Fixador de fundos Fijador de fondos Bottom fixer	<b>L</b> 15x  Cantoneira plástica Cantonera plástica Plastic angle brackets
<b>M</b> 06x  Suporte cabideiro meia cana Soporte de percha Coat hanger support	<b>N</b> 01x  Perfil "I" 350mm Perfil "I" 350mm Profile "I" 350mm	<b>O</b> 08x  Distanciador de corrediça Distanciador de deslizamiento Sliding spacer	<b>P</b> 03x  Cabideiro Madeira 578mm 578 mm de suspensión de madera 578 mm wooden hanger	<b>Q</b> 18x  Calço metal 5mm Calzado metálico 5mm 5mm metal shim	<b>R</b> 18x  Dobradiça metal 26mm Bisagra de metal 26mm 26mm metal hinge
<b>S</b> 02x  Corrediça metal 350mm Corredera de metal 350mm Sliding metal 350mm	<b>T</b> 06x  Perfil puxador visália 516mm Perfil mango 516mm Visalia Profile 516mm	<b>U</b> 04x  Porca cilíndrica Tuerca cilíndrica Cylindrical nut	<b>V</b> 27x  Adesivo tapa parafuso 10mm Adhesivo tapón de tornillo 10mm Bolt cover adhesive 10mm	<b>W</b> 01x  Sachê de cola Bolsa de pegamento Glue bag	<b>X</b> 01x  Etiqueta resinada Briz Etiqueta resinada Briz Briz resin label
<b>Y</b> 06x  Pé "U" 50x40x100mm Pie "U" 50x40x100mm Foot "U" 50x40x100mm	<b>Z</b> 12x  Porca sextavada Tuerca hexagonal Hexagon nut				

### Requisitos para montagem Requisitor para la montaje Assembly Requirements

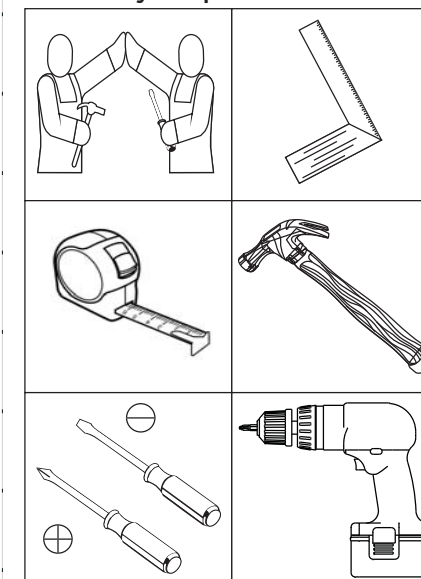

Imagens meramente ilustrativas  
Imágenes meramente ilustrativas  
Images for illustration only

### AVISO

Para limpeza de seu móvel, use uma flanela seca ou umedecida, e não utilize produtos químicos que possam danificar seu produto.

### SISTEMA DE MONTAGEM

O sistema de montagem dos produtos, funciona de acordo com a ordem crescente dos números indicados no desenho. Ex: 01, 02, 03, 04... até a conclusão da montagem.

### ADVERTENCIA

Para limpieza de su móvil, use una flanela seca o húmeda, y no utilice productos químicos que puedan dañar su producto.

### SISTEMA DE MONTAJE

El sistema de montaje de los productos funciona de acuerdo con el orden creciente de los números indicados en el dibujo. Ej.: 01, 02, 03, 04... hasta la conclusión del montaje.

### NOTICE

To clean your furniture, use a dry or wet cloth, and do not use chemicals that may damage your product.

### ASSEMBLY SYSTEM

The products' assembly system works according to the increasing order of the indicated numbers. For example: 01, 02, 03, 04 ... to the end of the assembly.

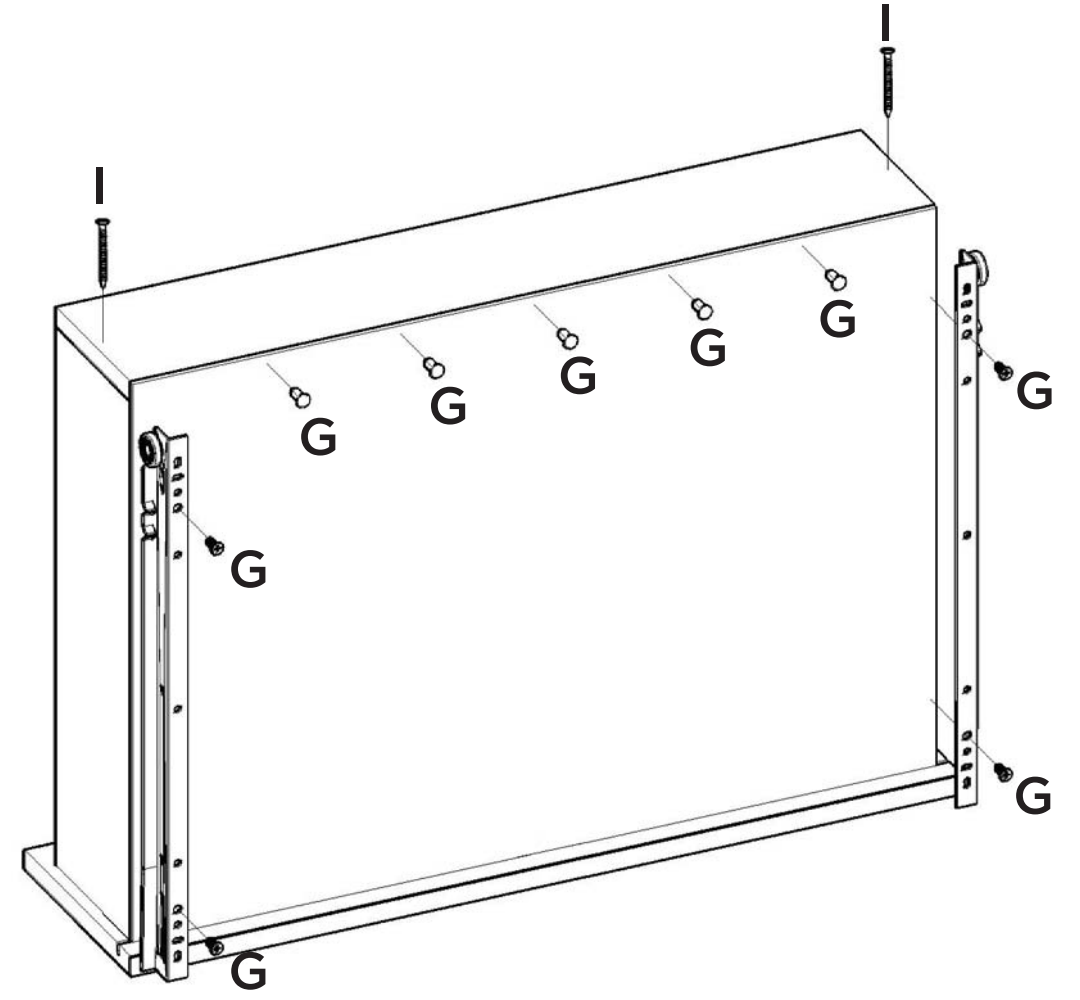
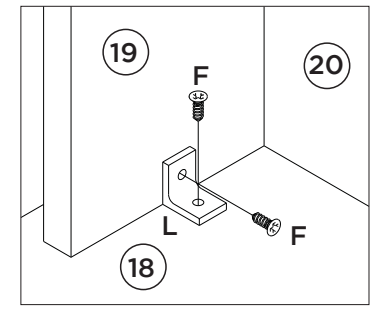
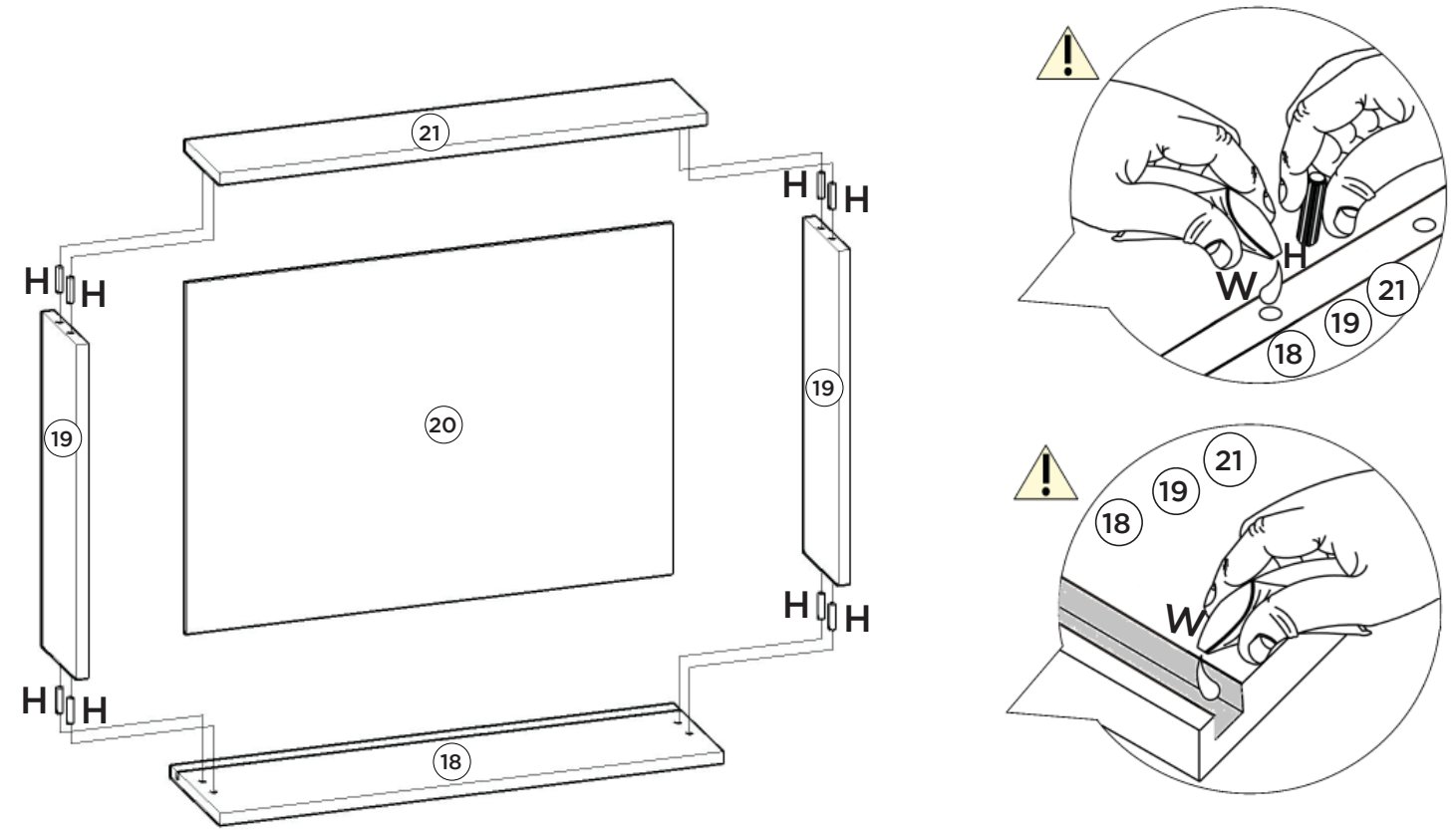
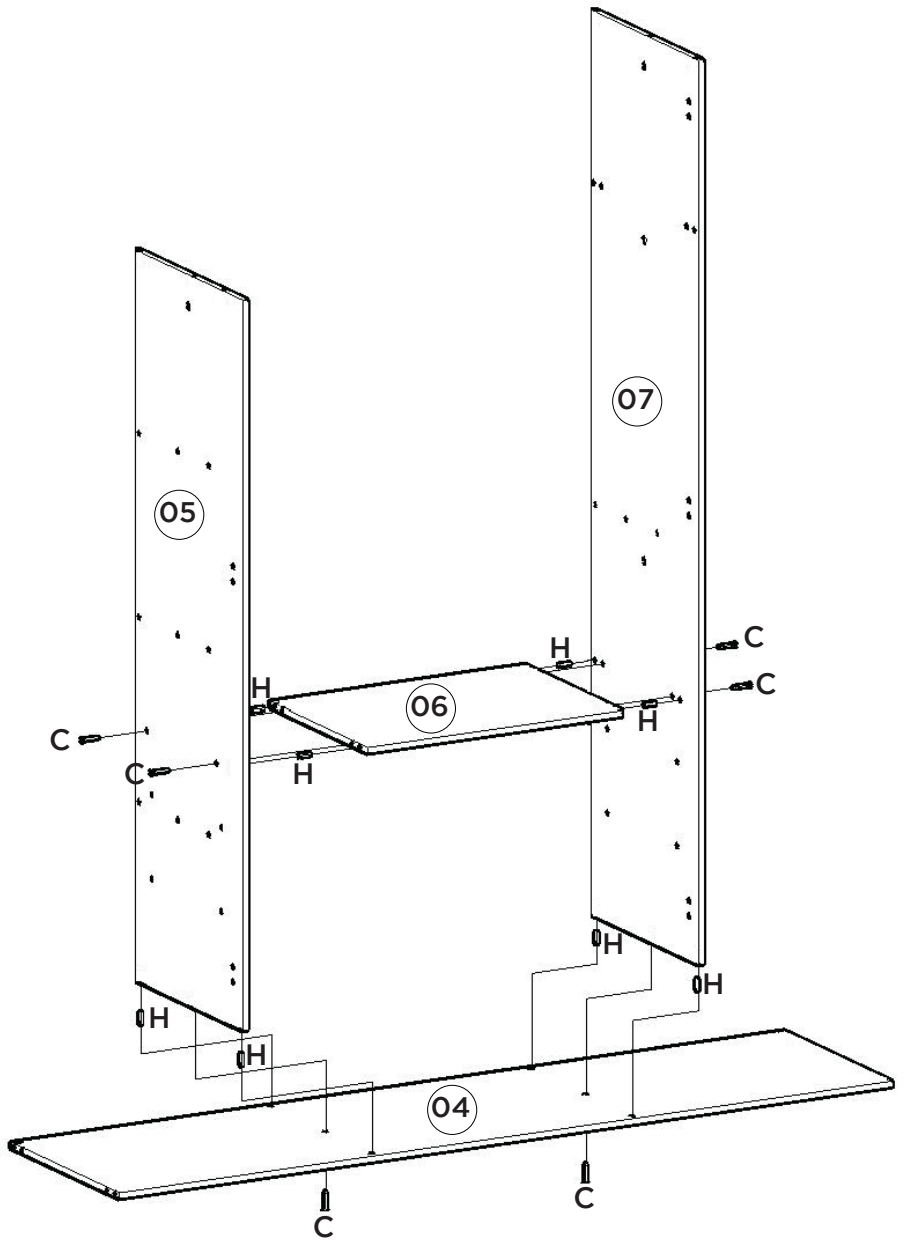
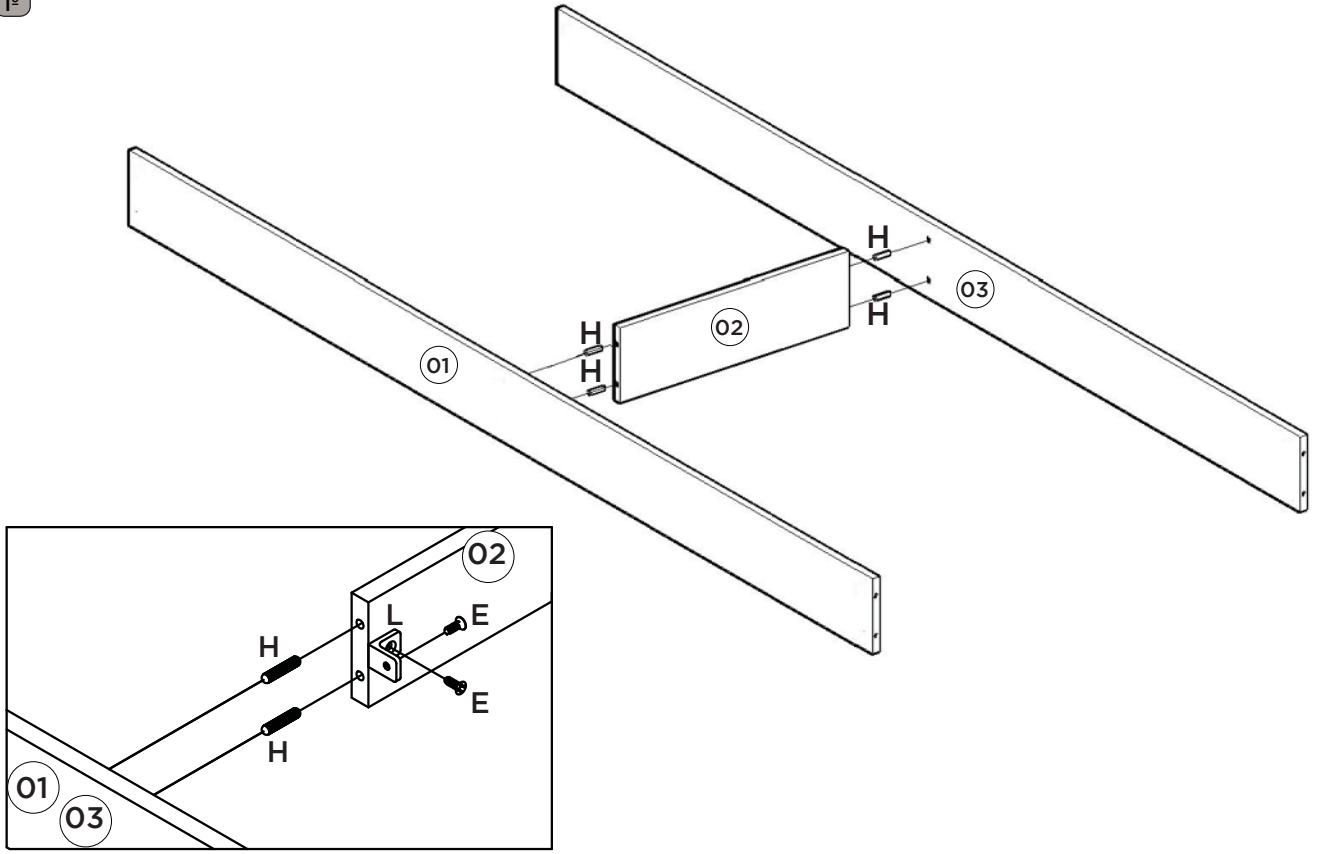

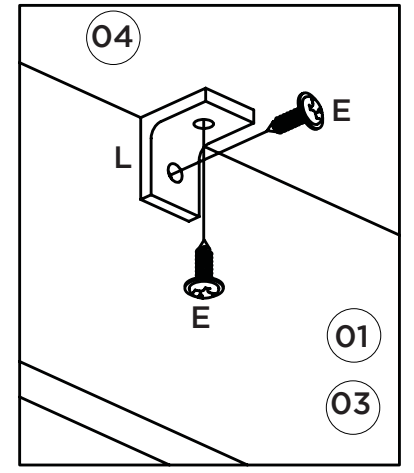
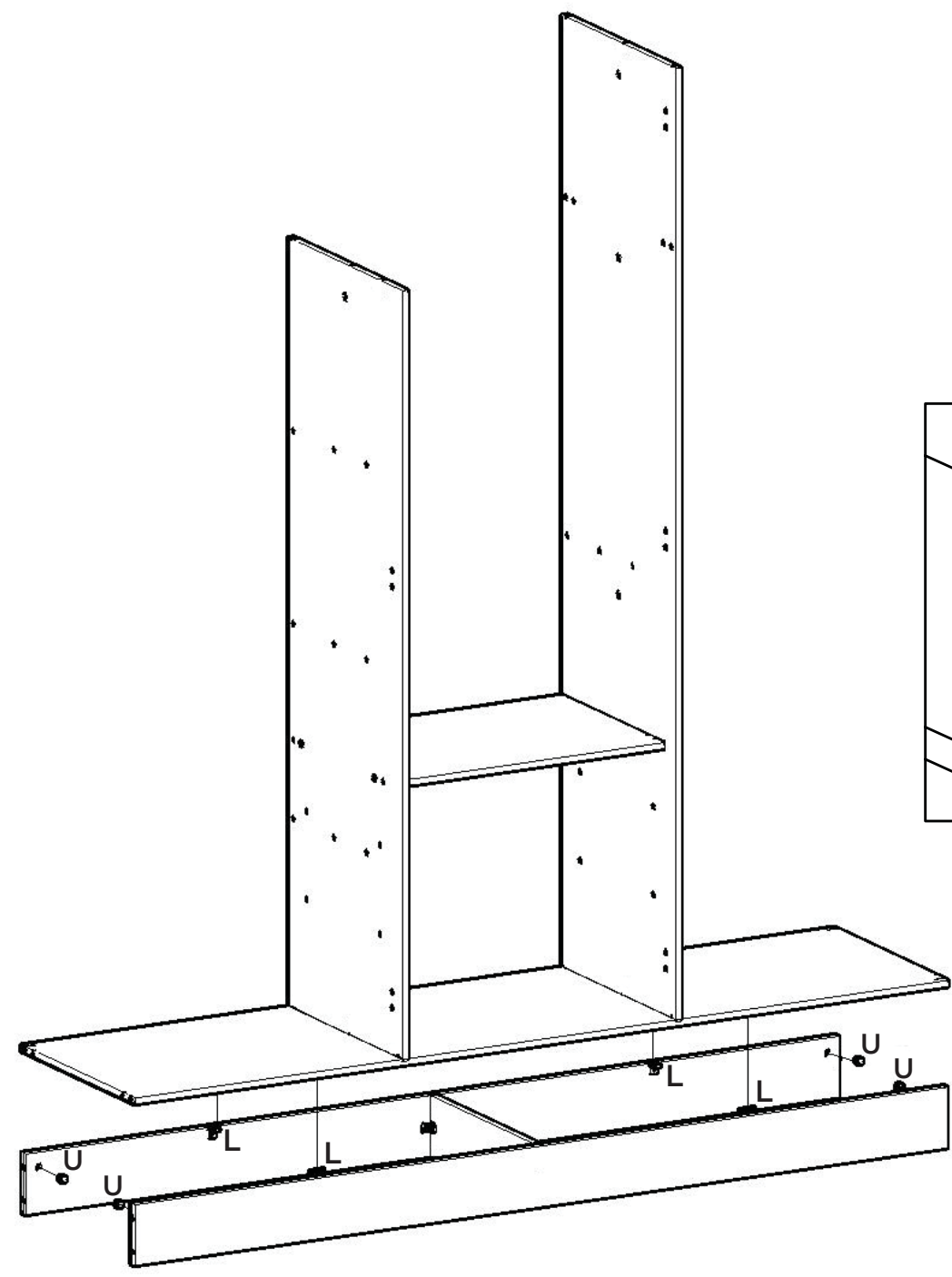
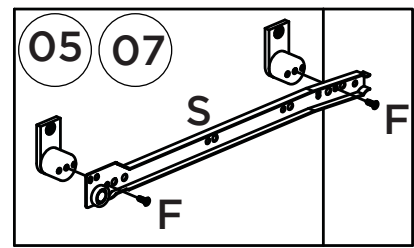
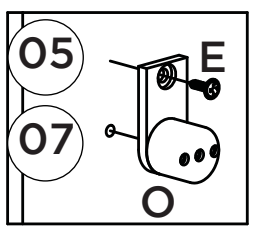
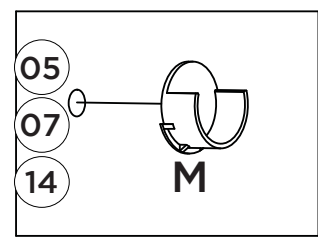
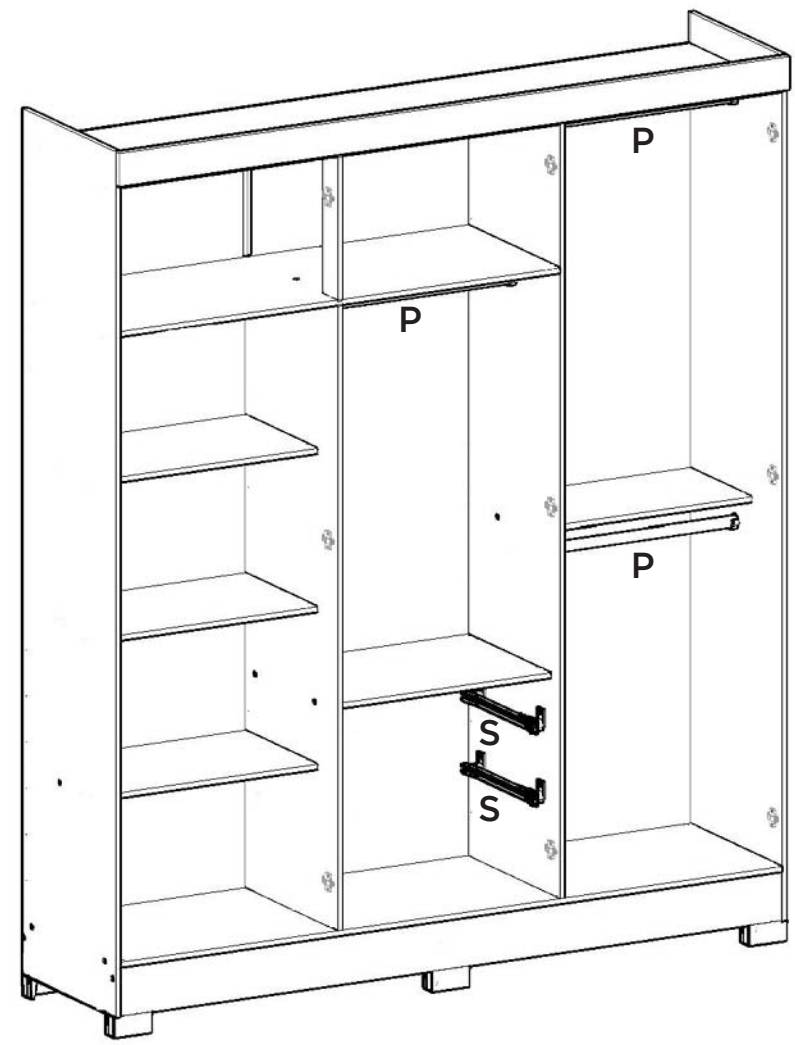

01  
03

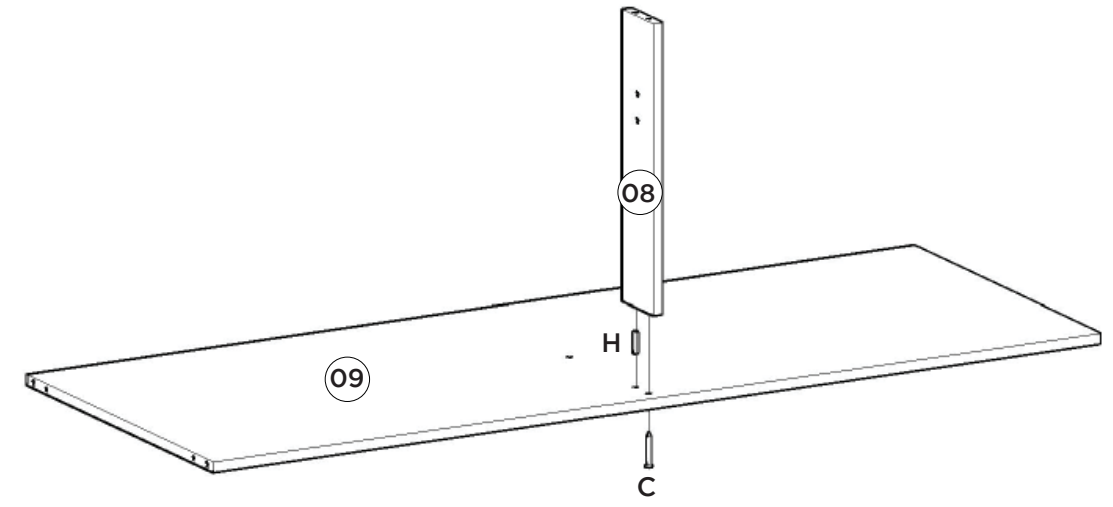
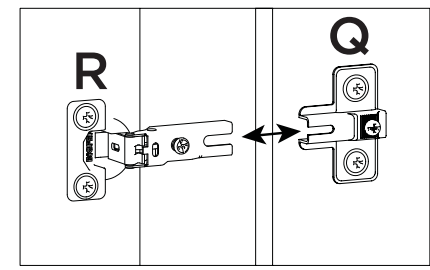
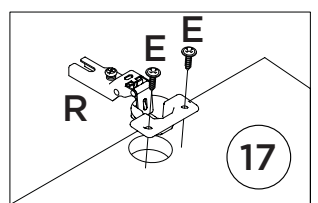
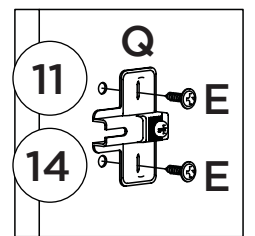
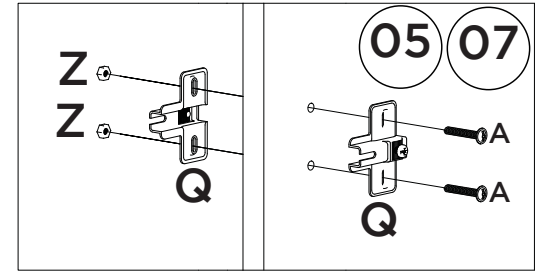
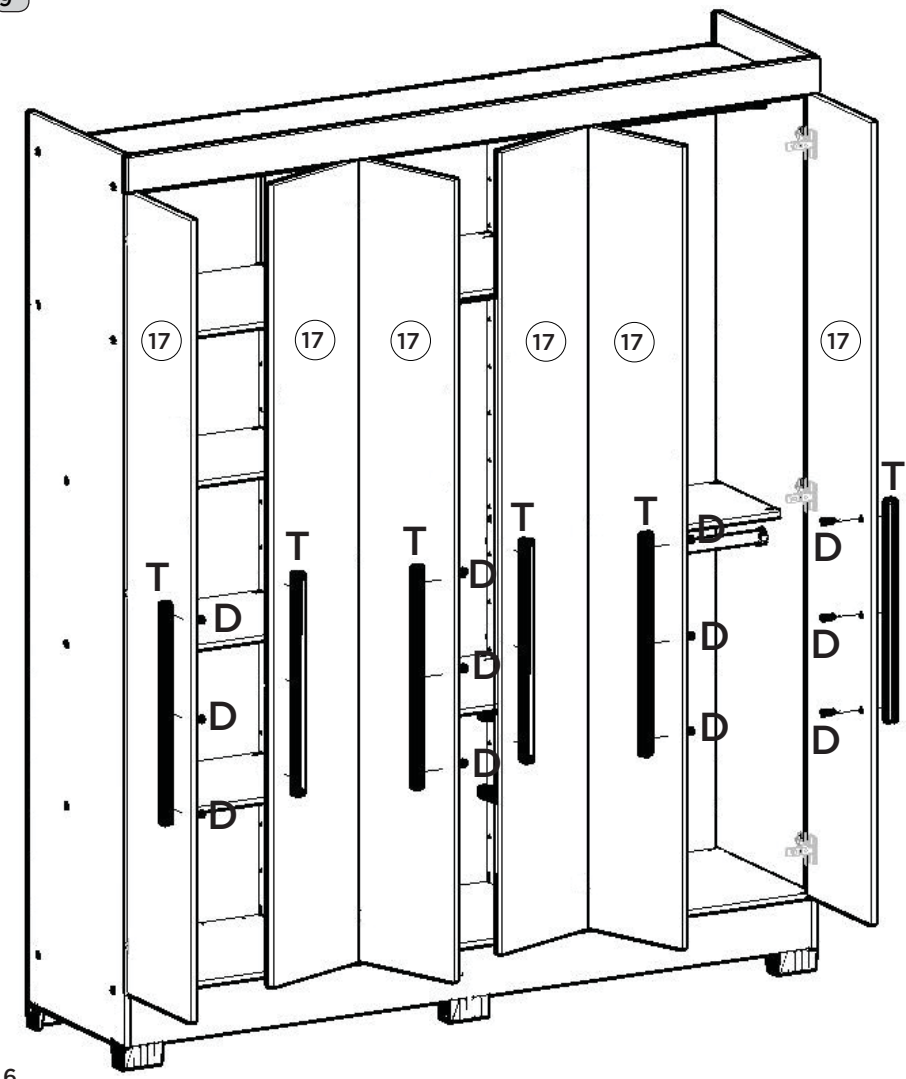

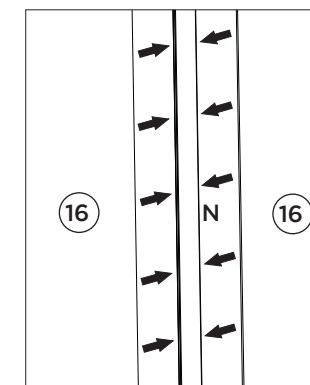
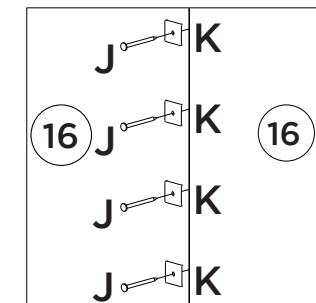
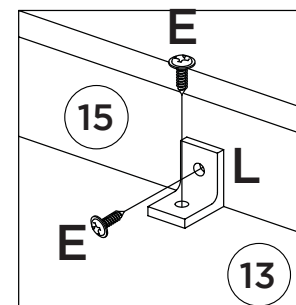
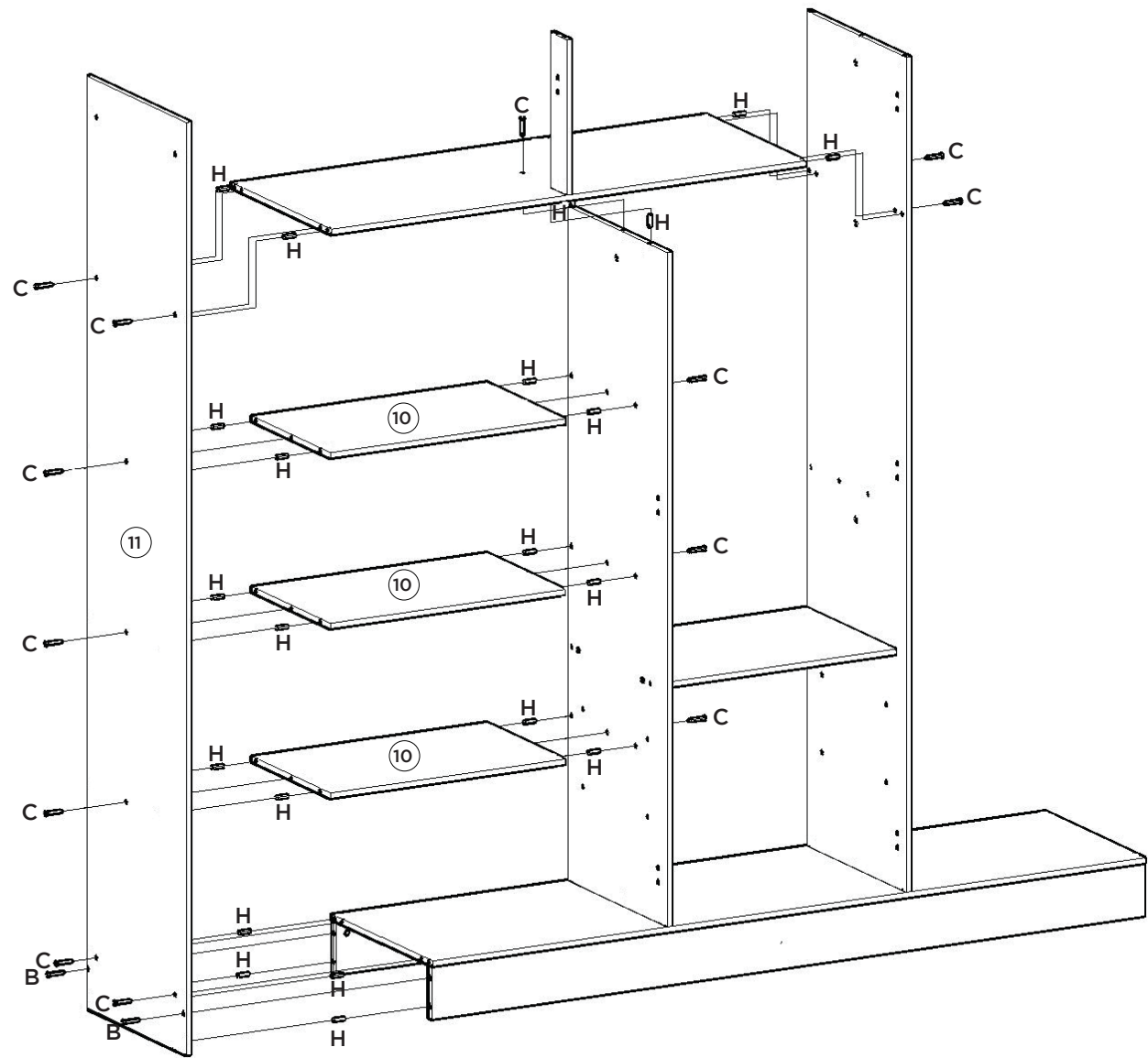

Fixar os pregos a uma distância de 120mm de um para outro.

Fijar las uñas a un distancia de 120 mm uno a otro.

Fix the nails at a distance of 120mm from one to the other

