

**Manual de montagem**  
**Assembly instructions**  
**Instrucciones de montaje**

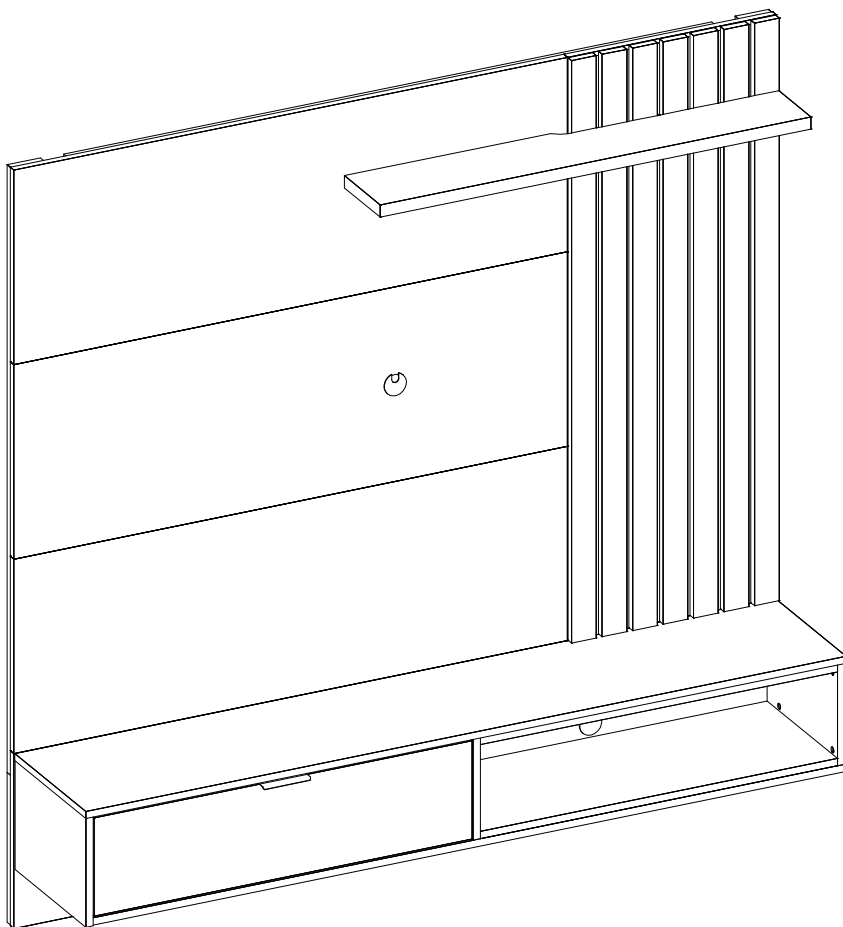

**Home Suspenso Tocantins 1.6**  
**1.636**





**Segurança:**

Manter os acessórios e os plásticos da embalagem fora do alcance de crianças e animais.  
A montagem incorreta pode provocar a queda do móvel, causando e lesões e danos.

**Montagem:**

Cobrir o local de montagem com a embalagem do próprio produto.  
Separar os acessórios e peças antes da montagem.  
Seguir o manual de montagem passo a passo para garantir o correto resultado final.  
Ferramentas para montagem não incluídas.

**Limpeza:**

Não molhar o móvel e não expor em lugar úmido.  
Não expor o móvel próximo de fontes de calor.  
Limpar apenas com pano limpo e levemente úmido.



**Safety:**

Keep accessories and plastics out of the reach of children and animals.  
Incorrect assembly can cause the furniture fall causing injury and damage.

**Mounting:**

Cover the assembly space with the proper product packaging  
Separates accessories and mounting parts.  
Follow the assembly manual step by step to ensure the correct final result.  
Assembly tools not included.

**Cleaning:**

Do not wet the furniture and do not expose it in a humid place.  
Do not expose the furniture to sources of heat.  
Wipe only with a clean, slightly damp cloth.



**Seguridad:**

Mantenga los accesorios y los plásticos de embalaje fuera del alcance de los niños y los animales.  
Un montaje incorrecto puede provocar una caída del mueble provocando lesiones y daños.

**Montaje:**

Cubra el lugar de montaje con el propio embalaje del producto.  
Separa accesorios y piezas de montaje.  
Siga el manual de montaje paso a paso para asegurar el resultado final correcto.  
Herramientas de montaje no incluidas.

**Limpeza:**

No moje los muebles y no los exponga en un lugar húmedo.  
No exponga los muebles a fuentes de calor.  
Limpiar solo con un paño limpio y ligeramente humedecido.

COLIBRI - IND. COM. DE MÓVEIS LTDA.

Rua Rouxinol, 5530 - Fone/Fax (43) 3275 - 8600

Pq. Industrial XI - CEP 86.706-418 - Araçongas -PR

E-mail: [sac@colibrimoveis.com.br](mailto:sac@colibrimoveis.com.br)

Site: [www.colibrimoveis.com.br](http://www.colibrimoveis.com.br)





2h00

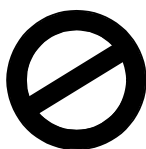
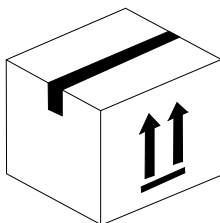
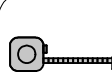
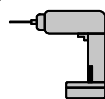
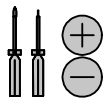

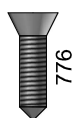

776

A  
28x



780

B  
100x



781

C  
06x



782

D  
04x



812

E  
04x



792

F  
12x



949

G  
22x



5225

H  
08x



162

I  
08x



183

J  
08x



163

K  
04x

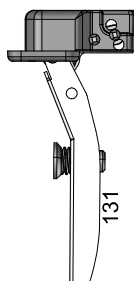

131

L  
02x

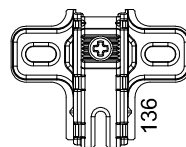

136

M  
02x



147

N  
09x

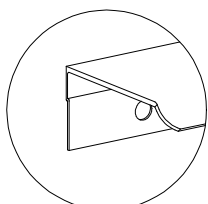

5285

O  
01x

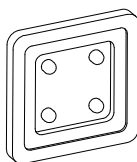

954

P  
01x

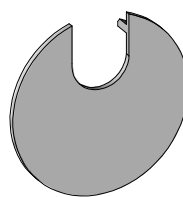

Q  
01x

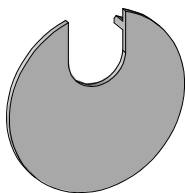

R  
01x

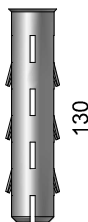

S  
12x

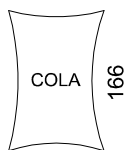

T  
02x

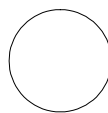

U  
04x

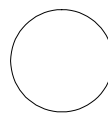

V  
06x

1.636.A0				
Cód.	Peças	Piece	Pieza	Qtd.
01	Prateleira superior	Top shelf	Estante superior	1
02	Tampo	Cover	Cubierta	1
03	Apoio	Support	Apoyo	1
04	Prateleira inferior	Bottom shelf	Estante inferior	1
05	Base	Base	Base	1
06	Lateral esquerda	Left side	Lado izquierdo	1
07	Batente	Flap	Solapa	1
08	Divisão	Division	División	1
09	Lateral direita	Right side	Lado derecha	1
10	Porta	Door	Puerta	1
11	Painel superior	Top panel	Panel superior	1
12	Painel superior cen	Top center panel	Panel central superior	1
13	Painel inferior cen	Lower center panel	Panel central inferior	1
14	Painel inferior	Bottom panel	Panel inferior	1
15	Painel lateral	Side panel	Panel lateral	1
16	Aplique	Apply	Aplicar	8
17	Travessa superior lat	Side upper crosspiece	Travesaño superior lateral	2
18	Travessa inferior lat	Bottom side crosspiece	Travesaño inferior lateral	2
19	Travessa central mai	Larger center	Travesaño central más grande	1
20	Travessa fixação sup	Travessa fixation sup	Travesaño fijación superior	1
21	Travessa fixação inf	Travessa fixation inf	Travesaño fijación inferior	1
22	Travessa central men	Smaller central crosspiece	Travesaño central más pequeño	3
23	Travessa fixação sup men	Travessa fixation sup men	Travesaño fijación sup men	2
24	Travessa fixação inf men	Travessa fixation inf men	Travesaño fijación inf men	2

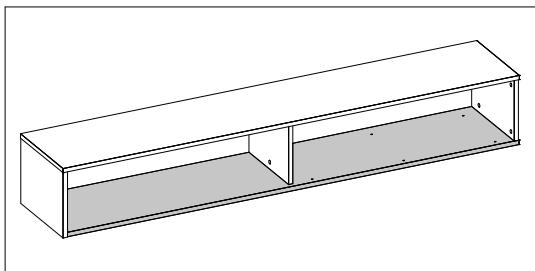

01

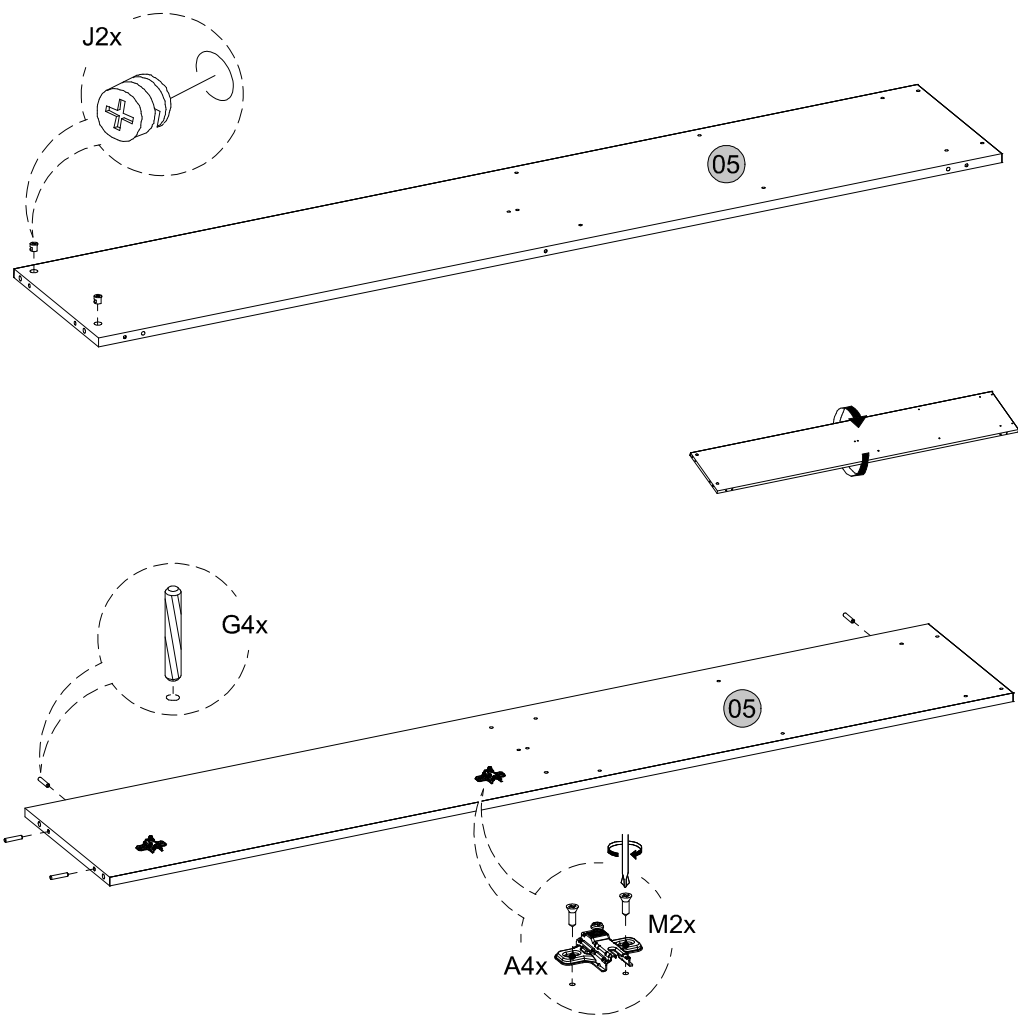

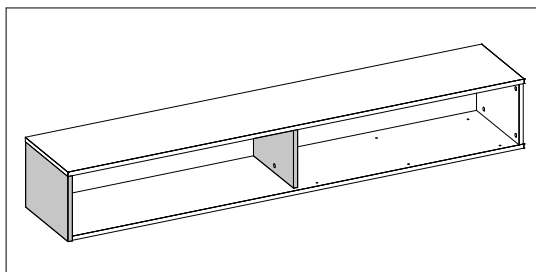

02

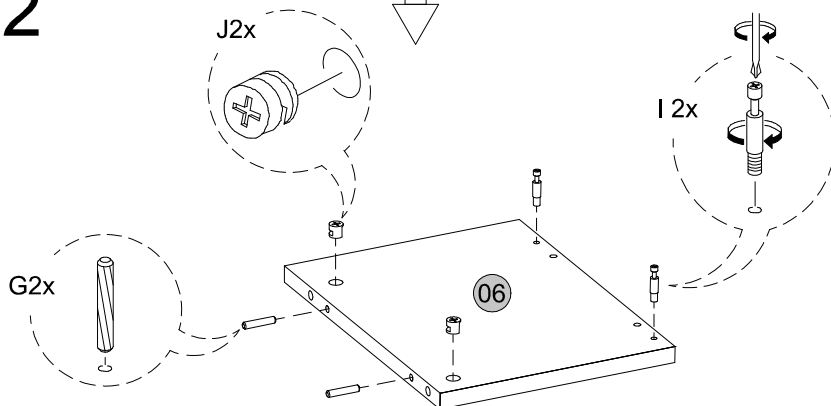

03

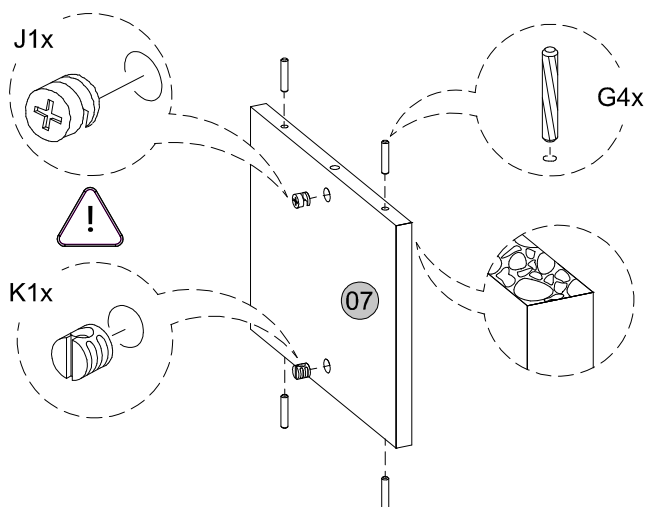

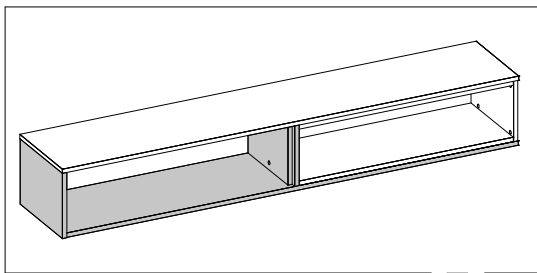

04

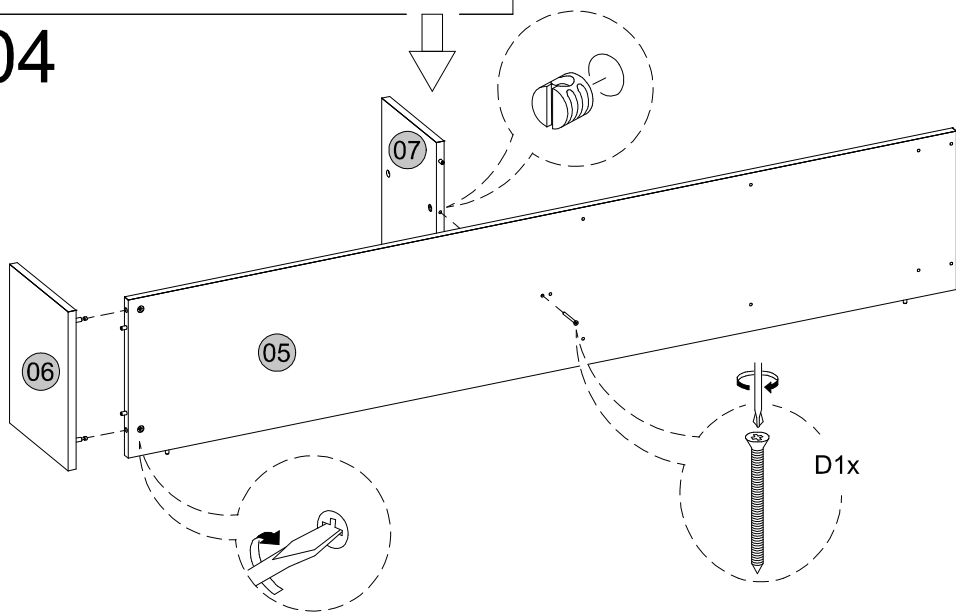

05

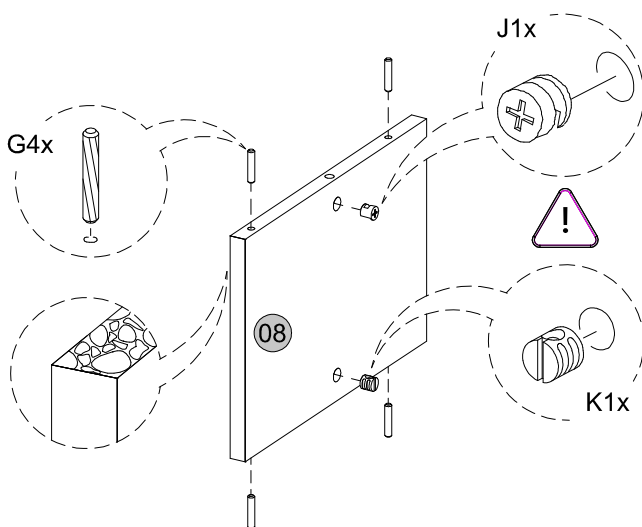



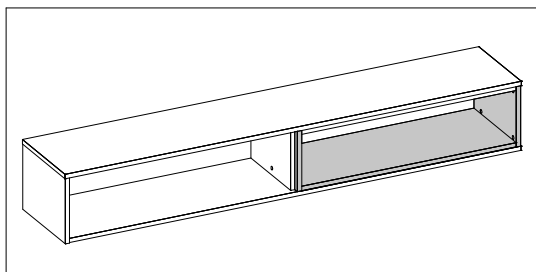

06

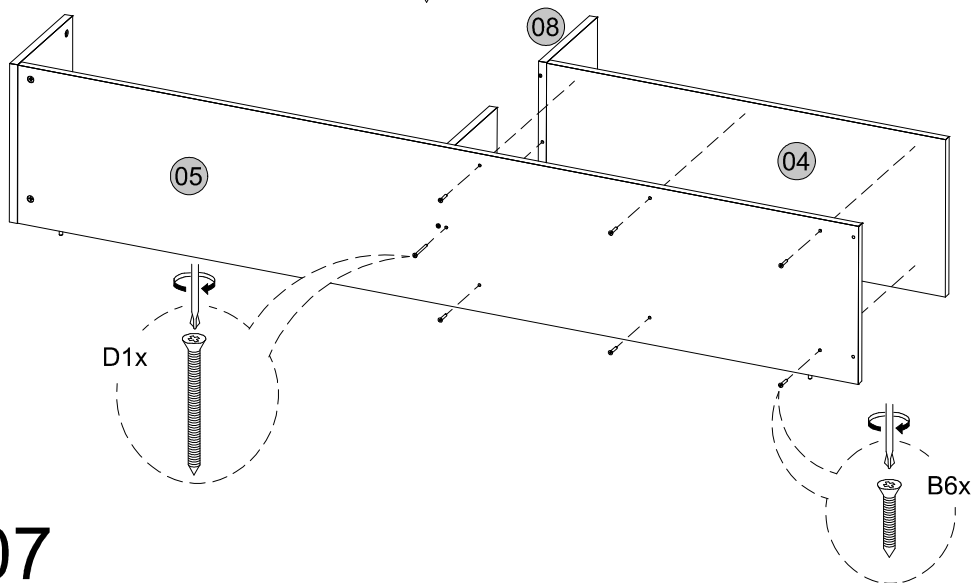

07

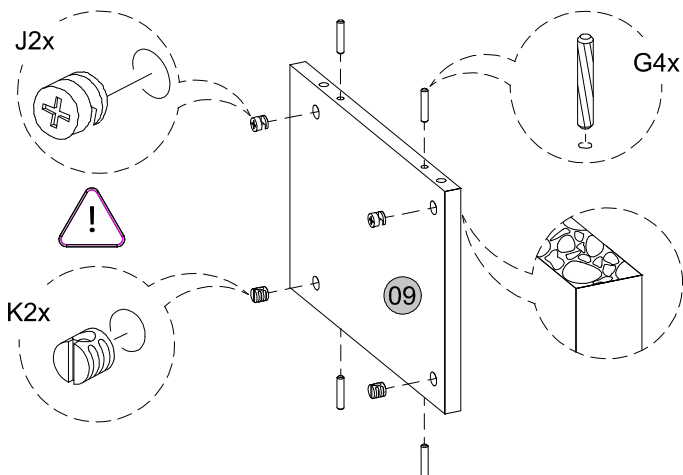

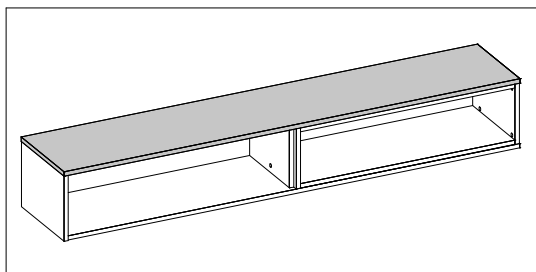

08

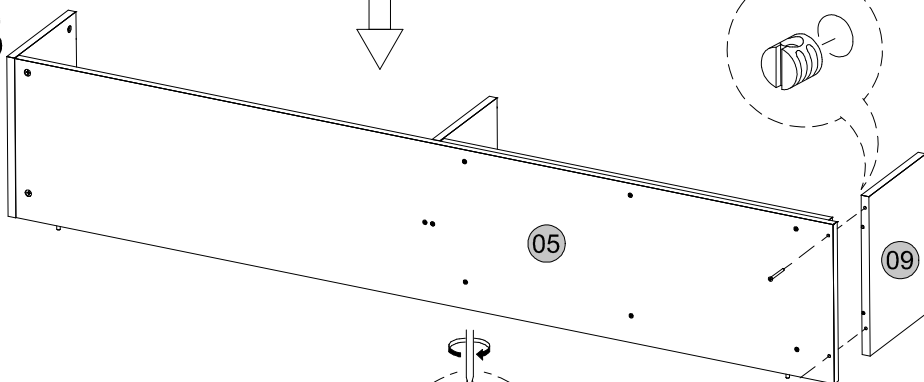

D2x

09

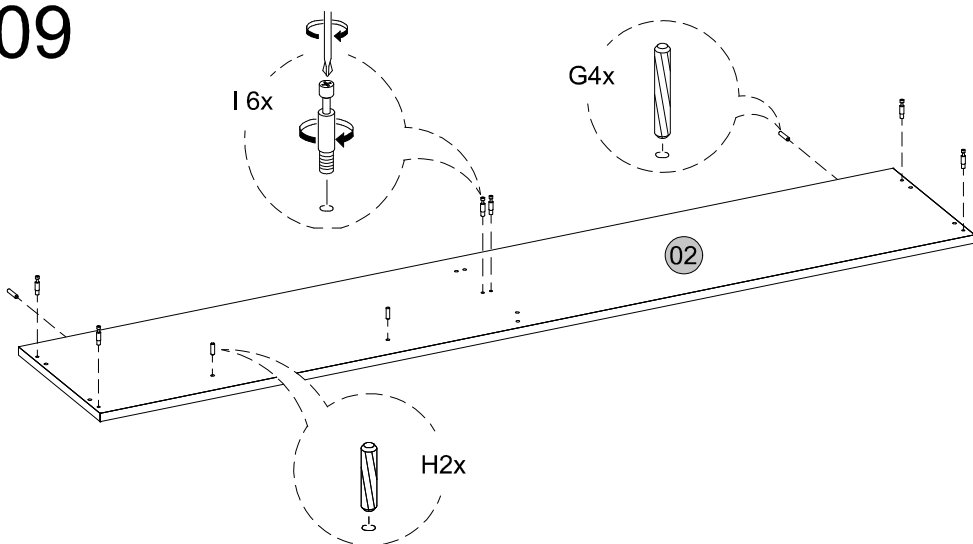

I 6x

G4x

H2x

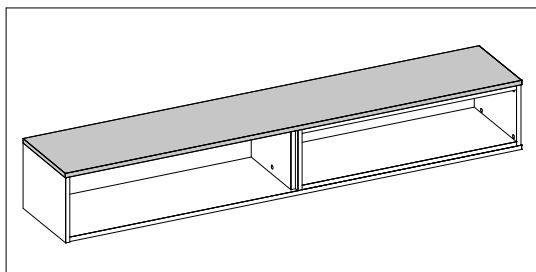

10

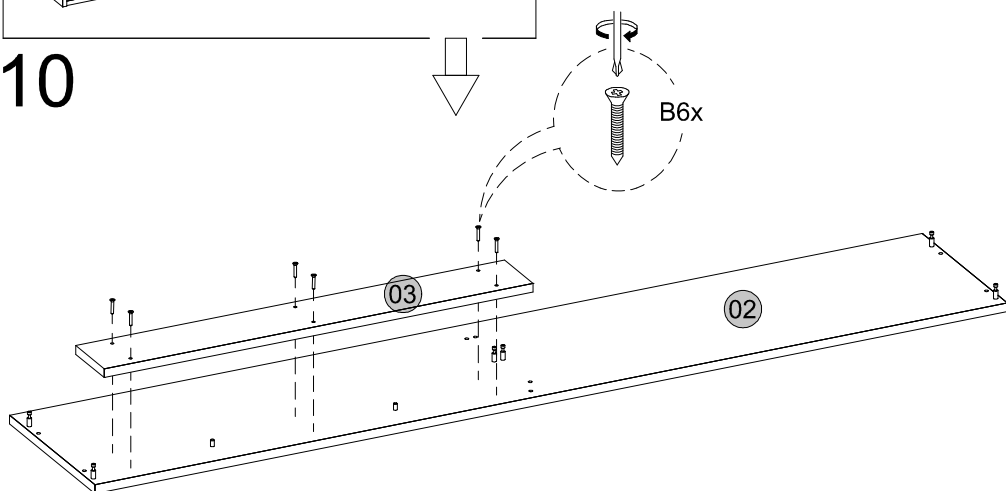

11

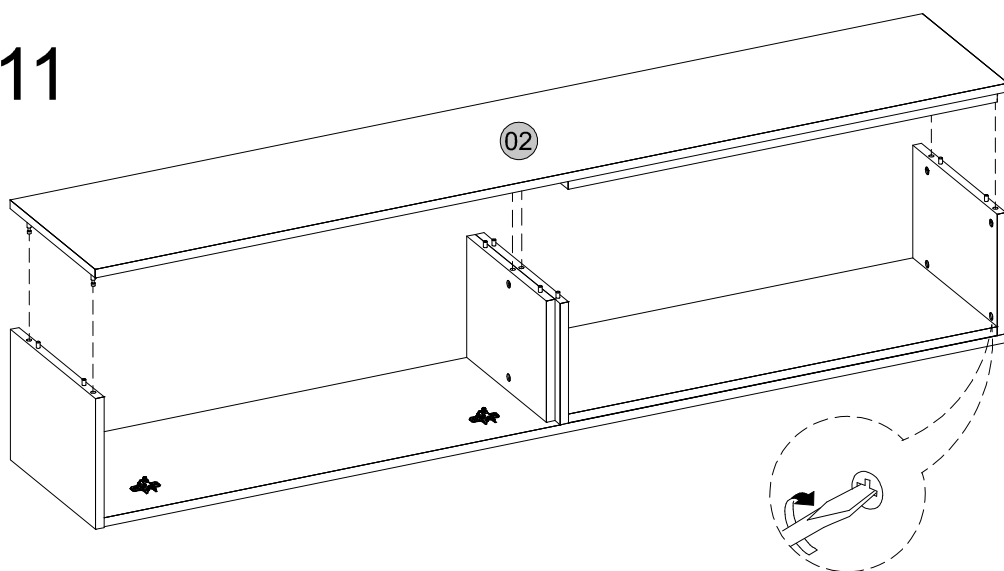

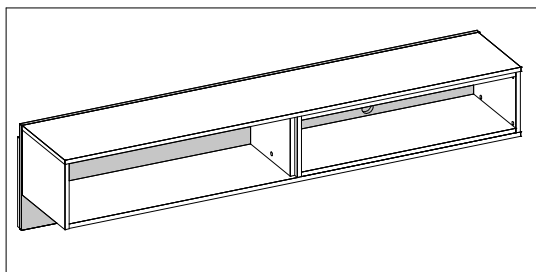

12

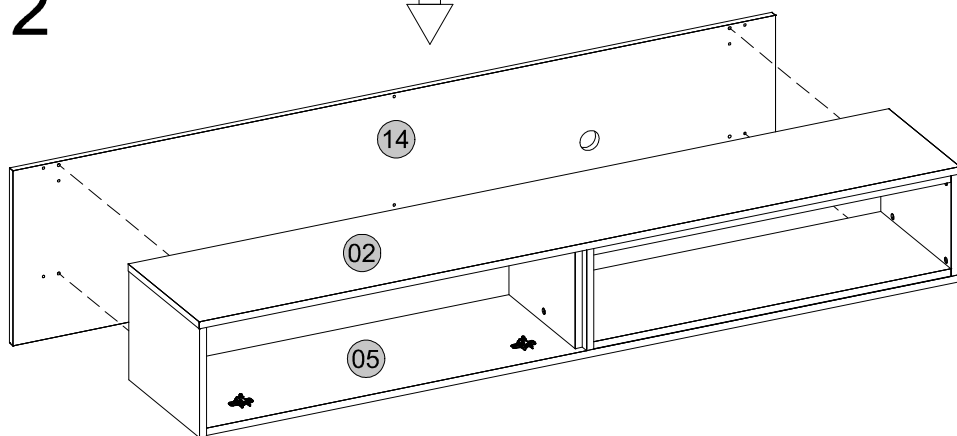

13

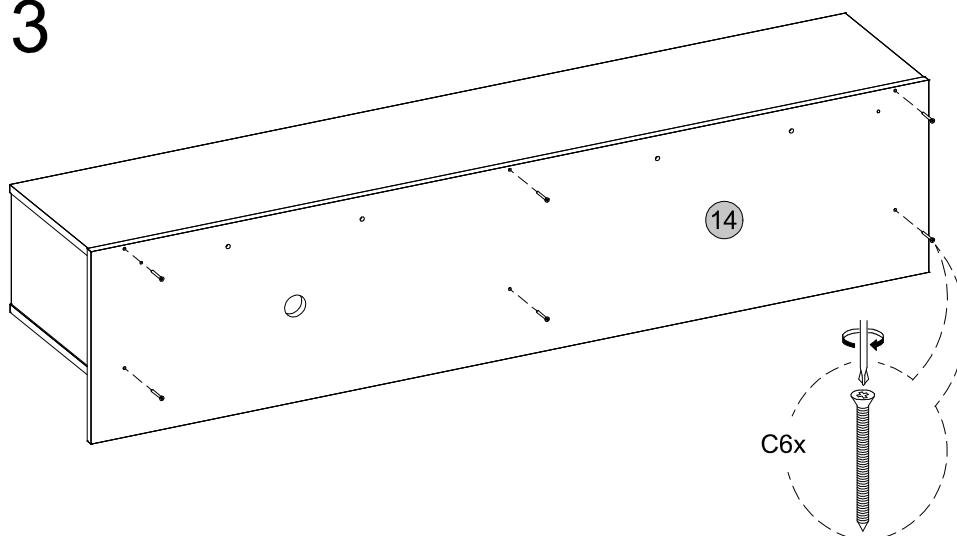

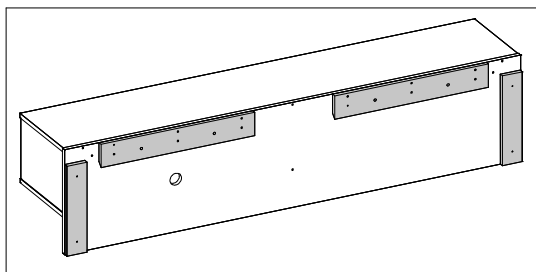

14

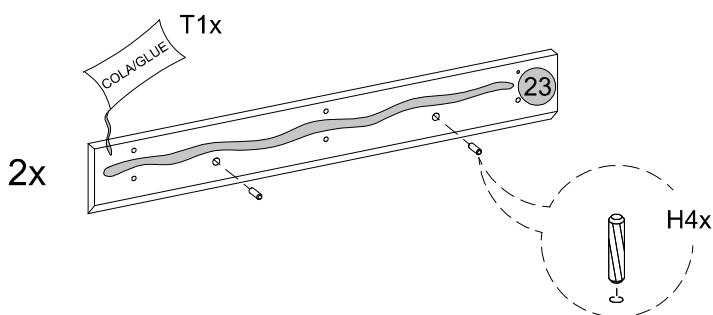

15

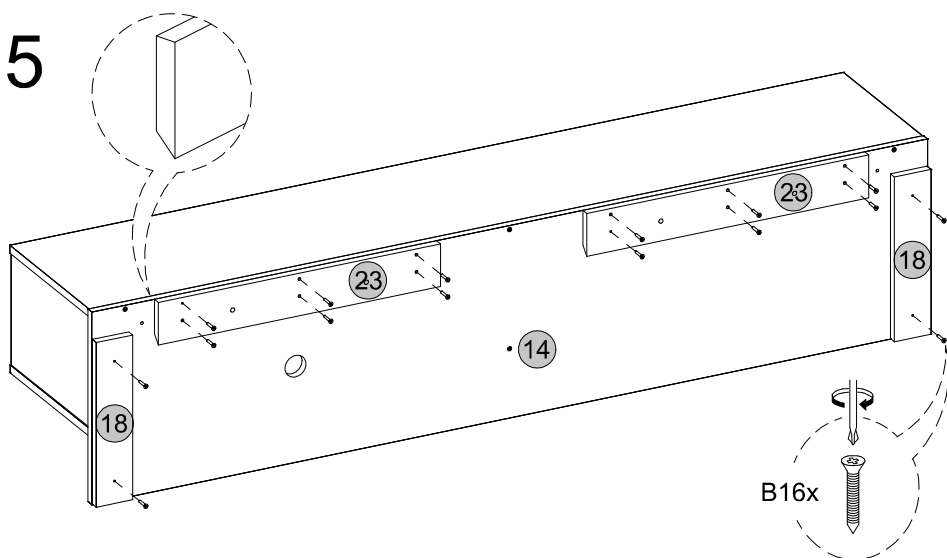

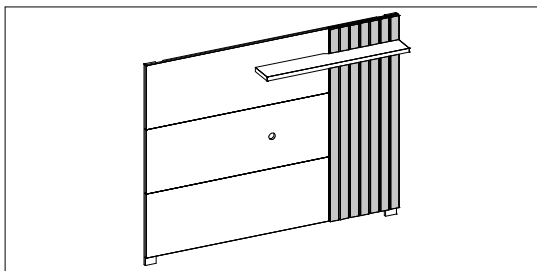

16

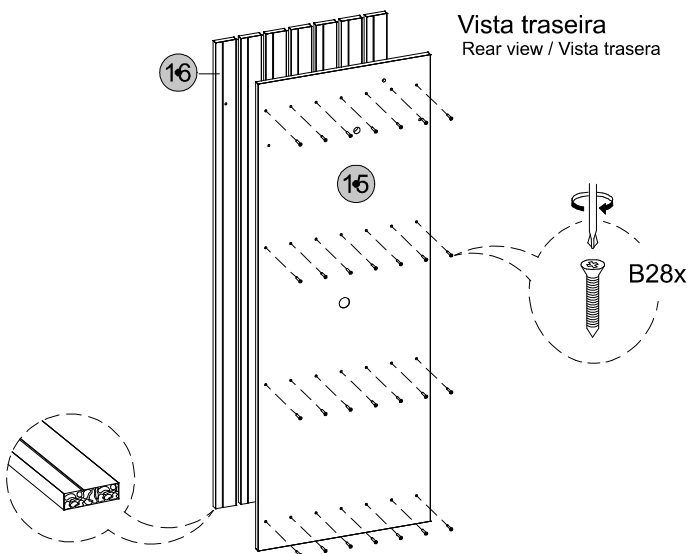
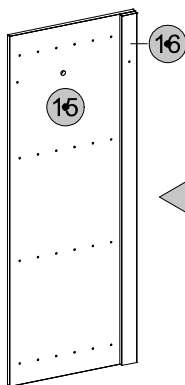
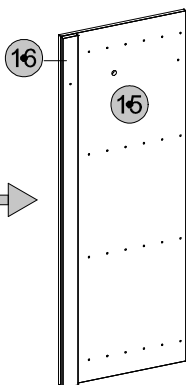

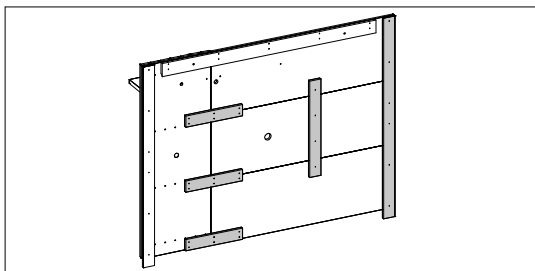

17

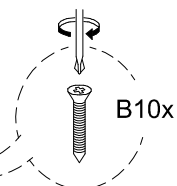
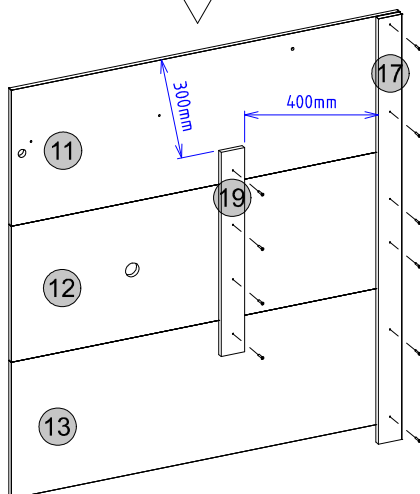

18

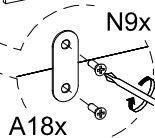
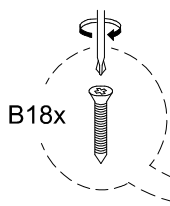
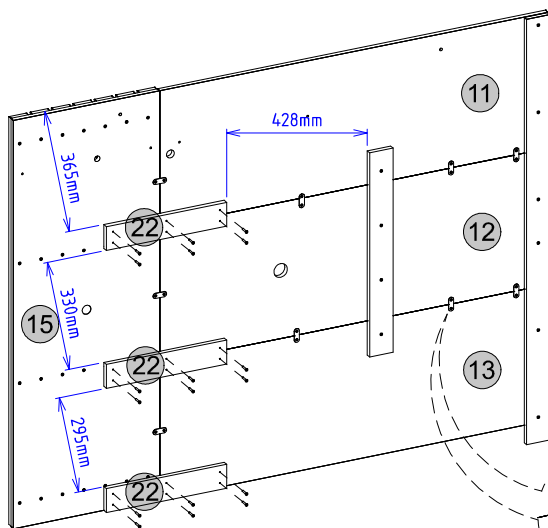

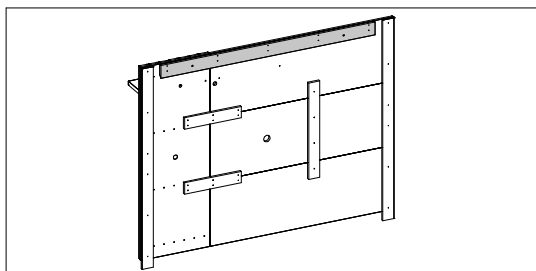

19

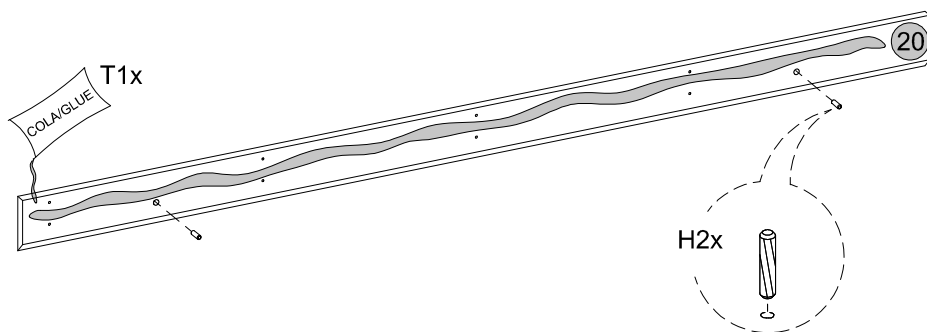

20

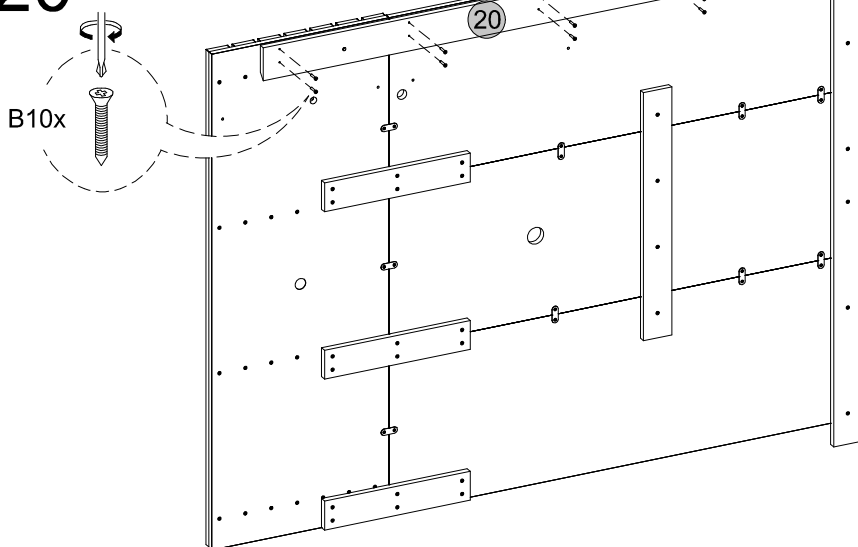



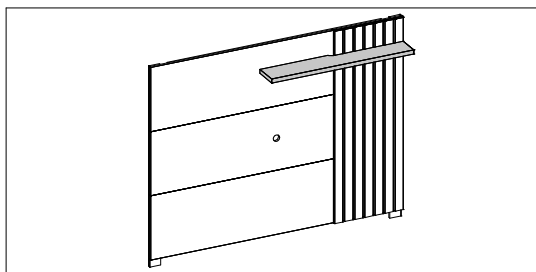

21

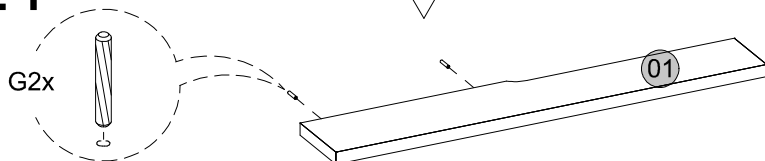

22

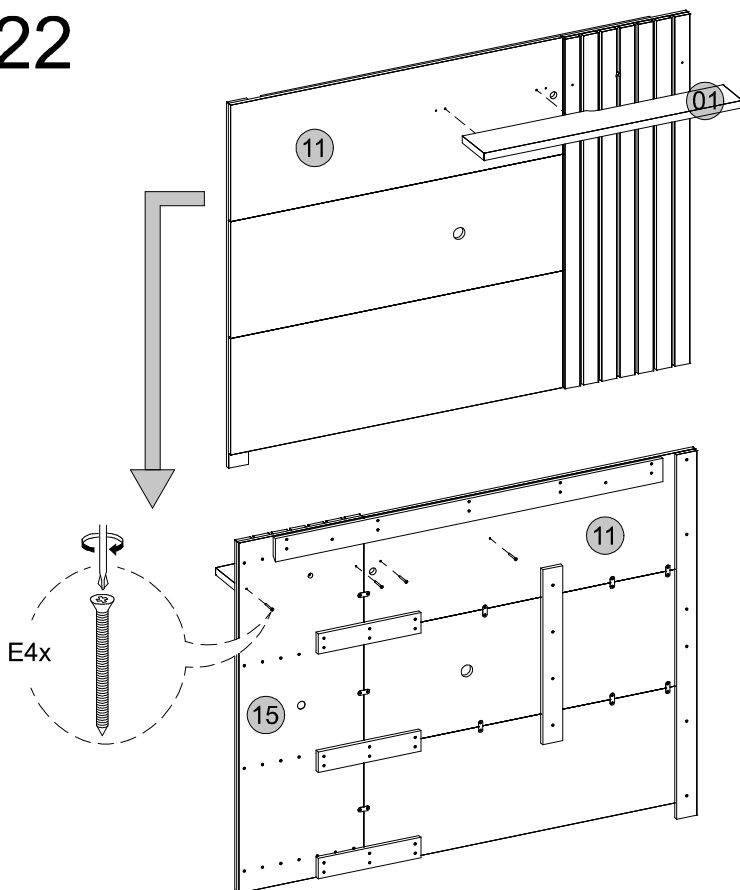

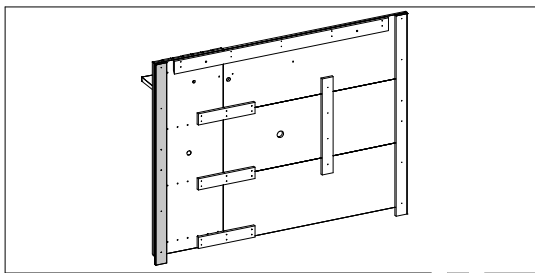

23

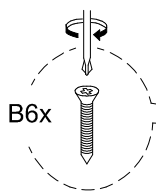

B6x

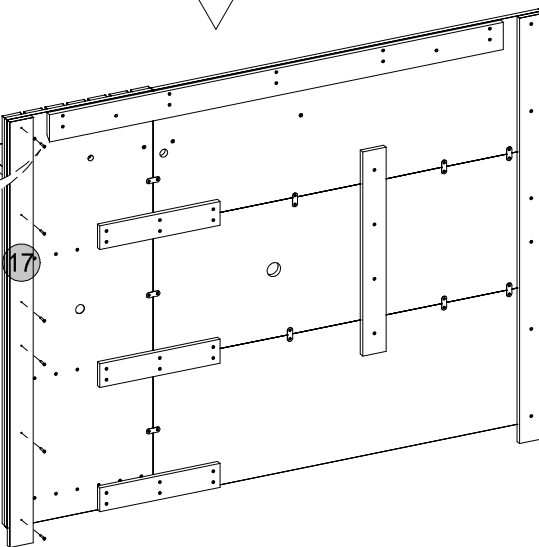

24

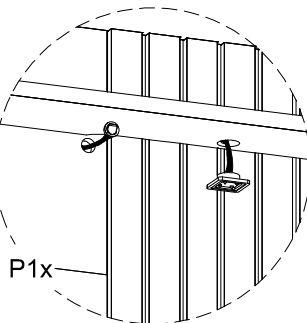
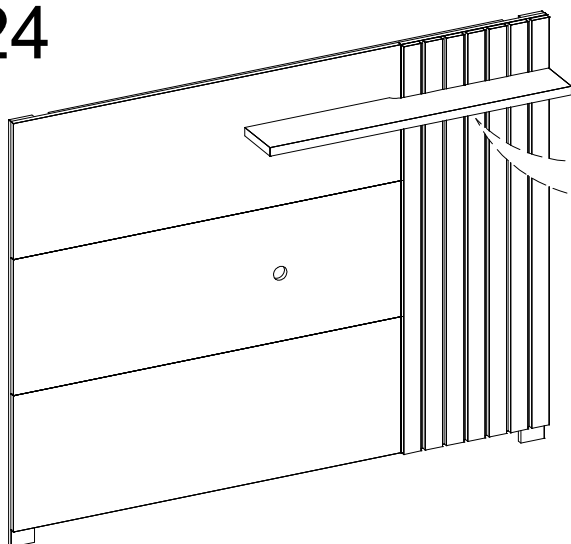

P1x

Parede  
Wall/Pared

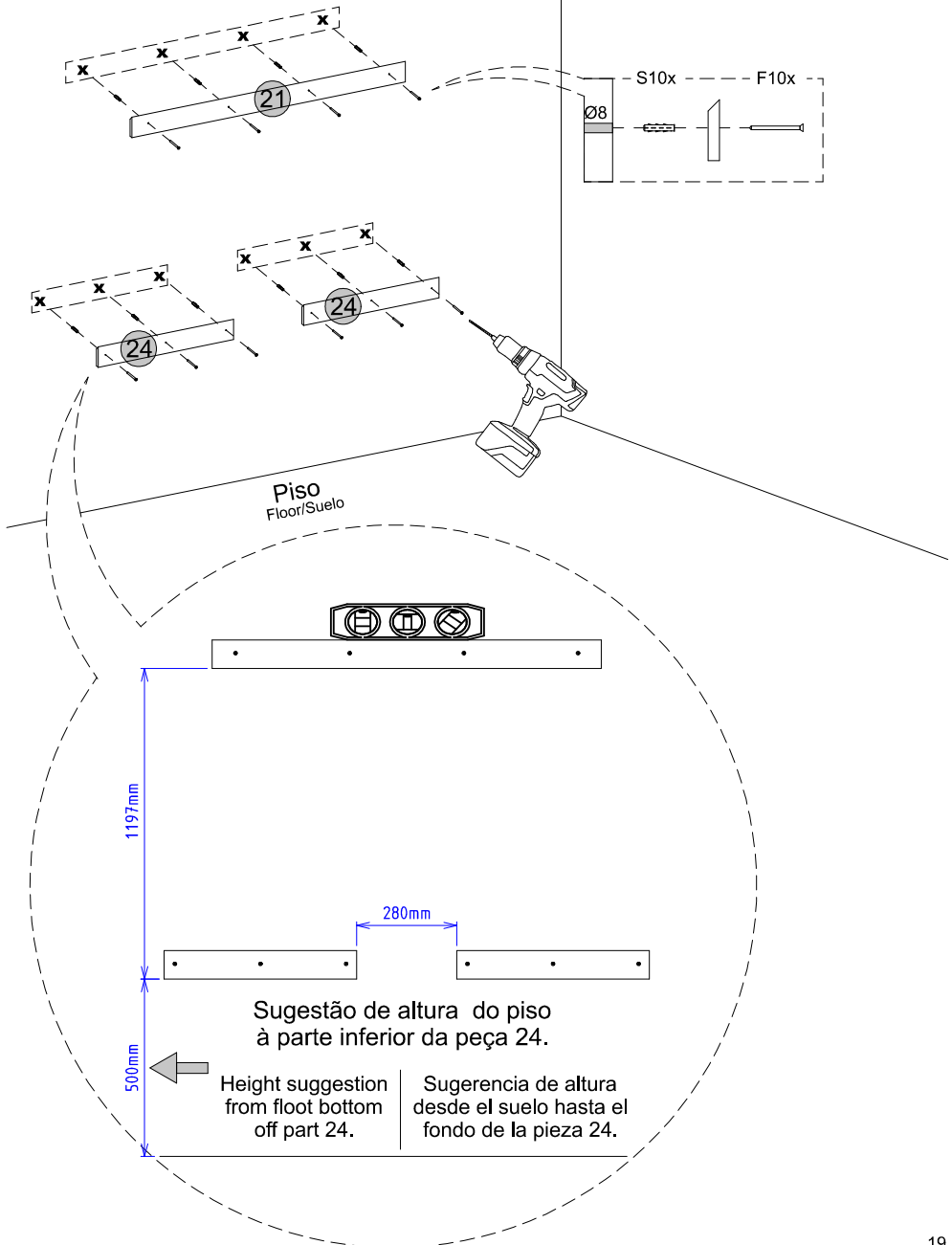

Parede  
Wall/Pared

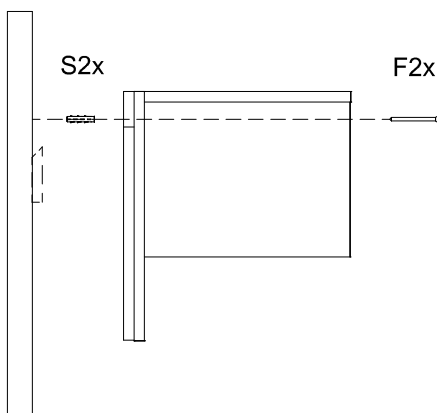
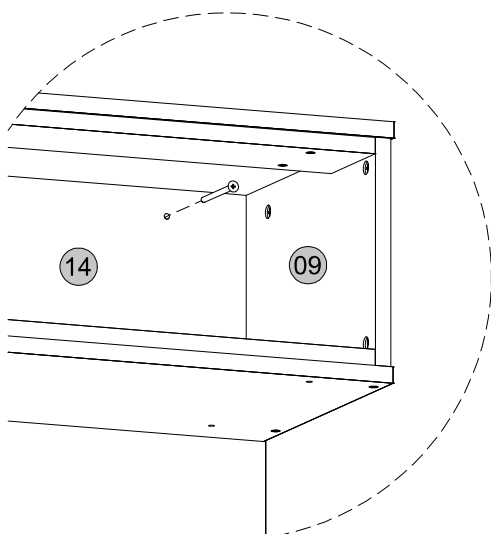
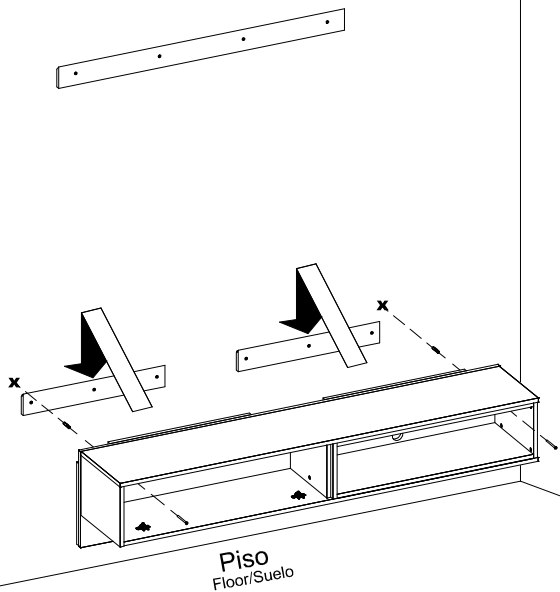

# 27

Parede  
Wall/Pared

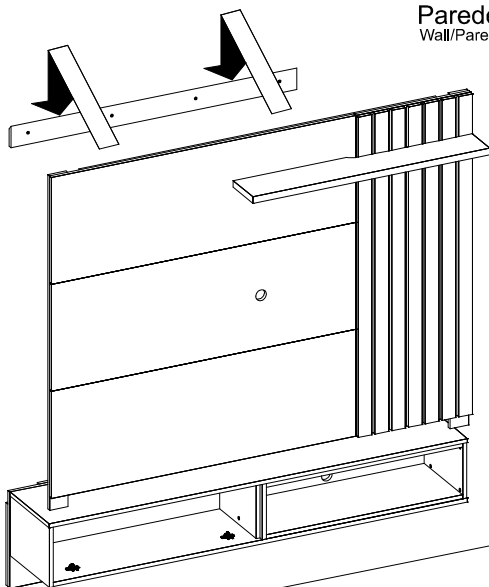

Piso  
Floor/Suelo

# 28

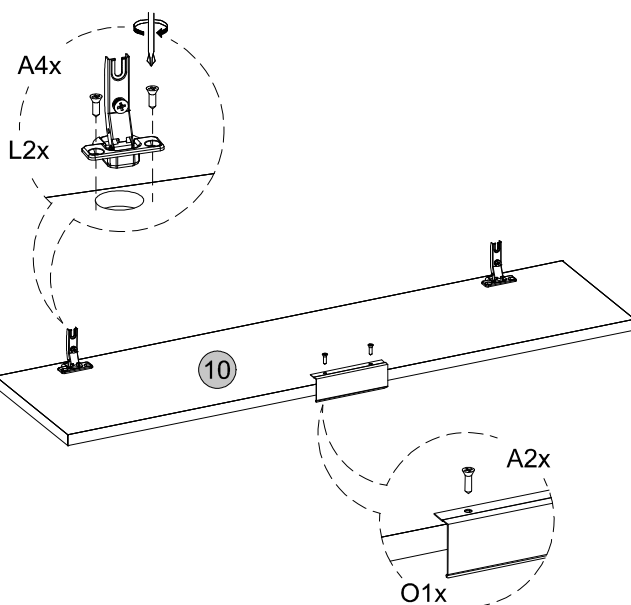

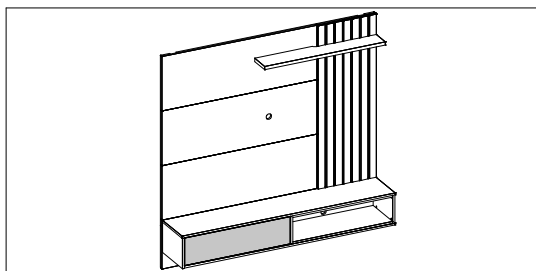

29

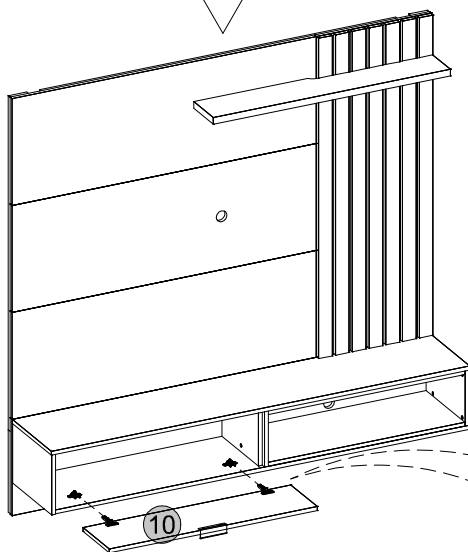

30

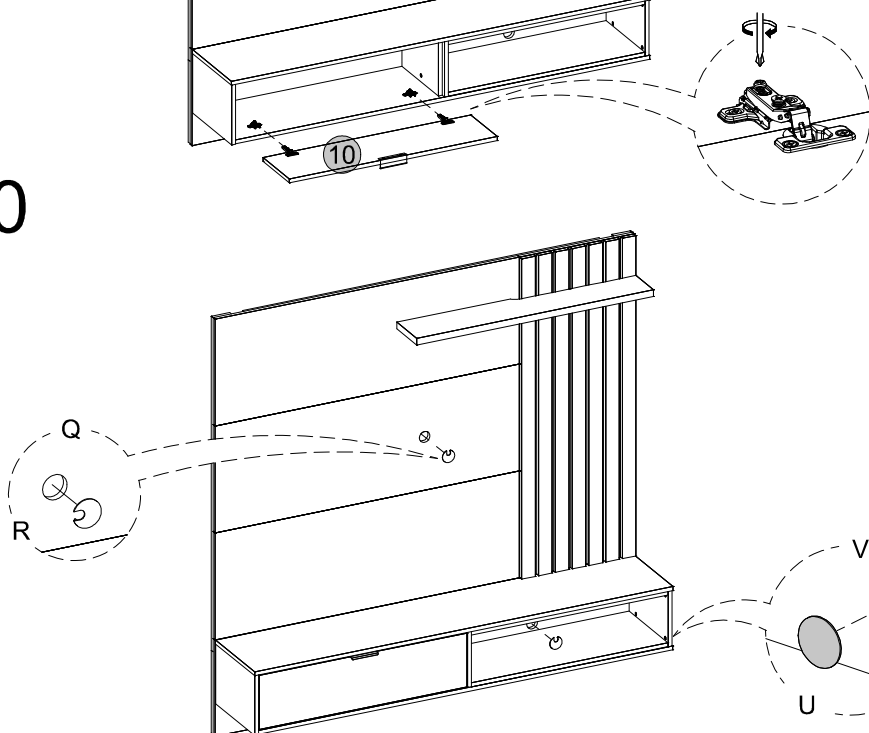

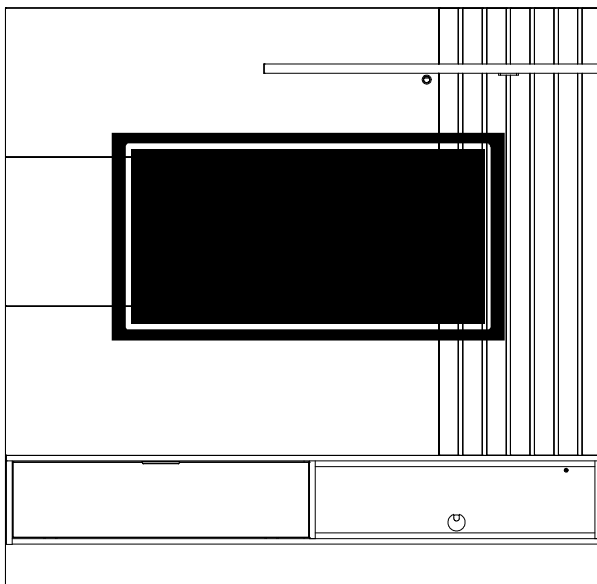
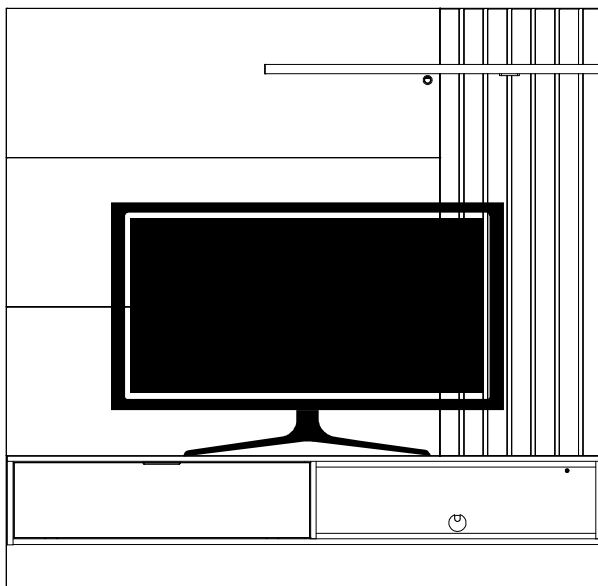

Medidas finais / Final measures / Medidas finales

Comprimento / Length / Largo : 1600mm

Altura / Height / Alto : 1560mm



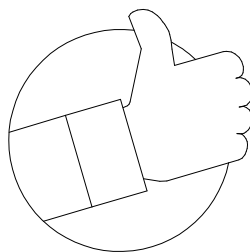
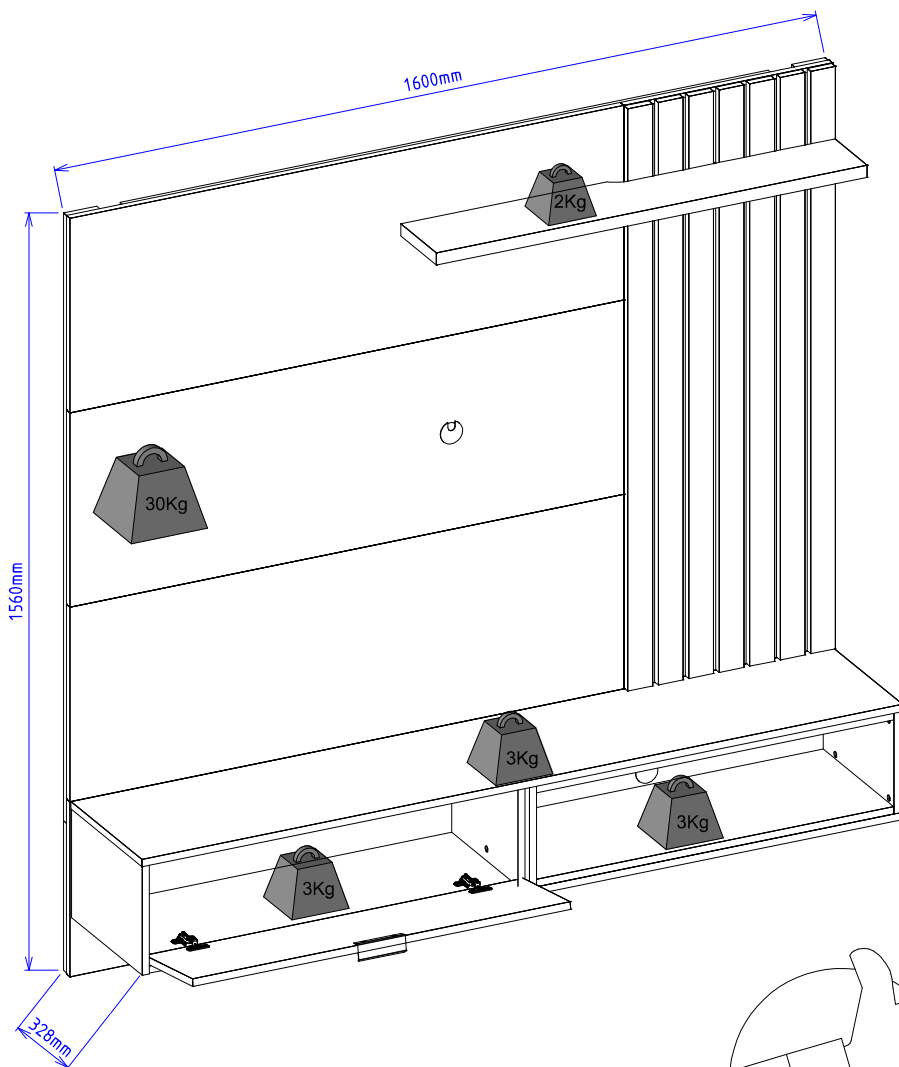
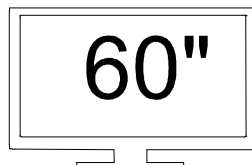



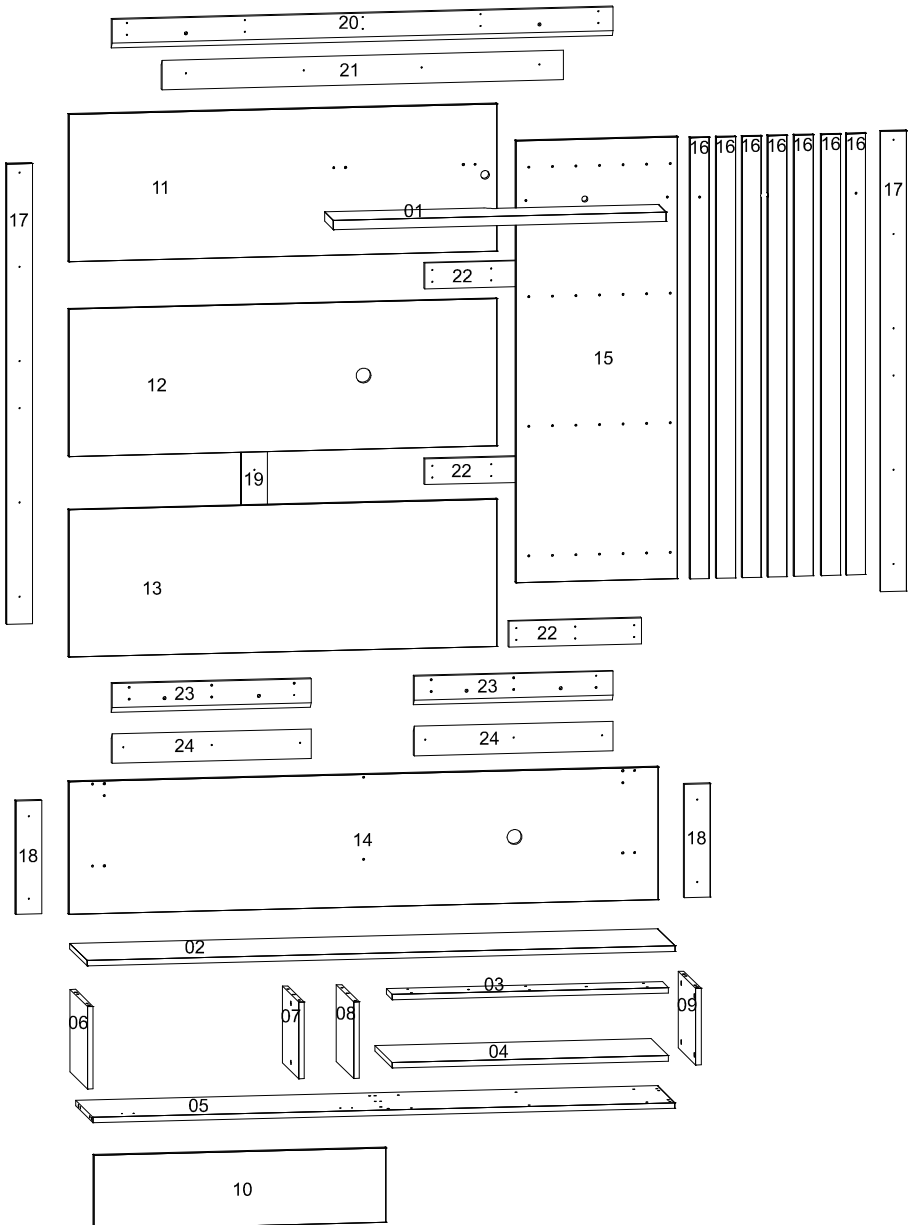















Profundidade / Depth / Profundidad : 328mm







Num.	Peças	Medidas	Qt.	M.P.	Vol.	Off W/Nogueira R	Preto F/Noce M
01	Prateleira superior	904x150x25	1	MDP	2	Nogueira R	Noce M
02	Tampo	1596x298x15	1	MDP	1	Off W	Preto F
03	Apoio	750x100x15	1	MDP	1	Nogueira R	Noce M
04	Prateleira inferior	750x295x15	1	MDP	1	Nogueira R	Noce M
05	Base	1580x296x15	1	MDP	1	Off W	Preto F
06	Lateral esquerda	297x224x15	1	MDP	1	Off W	Preto F
07	Batente	278x208x15	1	MDP	1	Off W	Preto F
08	Divisão	296x208x15	1	MDP	1	Nogueira R	Noce M
09	Lateral direita	296x208x15	1	MDP	1	Nogueira R	Noce M
10	Porta	793x202x15	1	MDP	1	Off W	Preto F
11	Painel superior	1162x400x15	1	MDP	2	Off W	Preto F
12	Painel superior cen	1162x400x15	1	MDP	2	Off W	Preto F
13	Painel inferior cen	1162x400x15	1	MDP	2	Off W	Preto F
14	Painel inferior	1600x360x15	1	MDP	1	Off W/Nogueira R	Preto F/Noce M
15	Painel lateral	1200x438x15	1	MDP	2	Off W	Preto F
16	Aplique	1198x52x15	7	MDP	2	Nogueira R	Noce M
17	Travessa superior lat	1250x70x15	2	MDP	1	Off W	Preto F
18	Travessa inferior lat	308x70x15	2	MDP	1	Off W	Preto F
19	Travessa central mai	600x70x15	1	MDP	1	Sem cor	Sem cor
20	Travessa fixação sup	1360x80x15	1	MDP	1	Sem cor	Sem cor
21	Travessa fixação inf	1090x80x15	1	MDP	1	Sem cor	Sem cor
22	Travessa central men	360x70x15	3	MDP	1	Sem cor	Sem cor
23	Travessa fixação sup men	540x80x15	2	MDP	2	Sem cor	Sem cor
24	Travessa fixação inf men	540x80x15	2	MDP	2	Sem cor	Sem cor

<b>(A)</b> 28x	<b>(B)</b> 100x	<b>(C)</b> 06x	<b>(D)</b> 04x	<b>(E)</b> 04x	<b>(F)</b> 12x	<b>(G)</b> 22x
						
Parafuso 3,5x14 Cabeça chata philips cod. 776	Parafuso 4,0x25 Cabeça chata philips cod. 780	Parafuso 4,0x40 Cabeça chata philips cod. 781	Parafuso 4,0x50 Cabeça chata philips cod. 782	Parafuso 5,0x50 Cabeça chata philips cod. 812	Parafuso 5,0x70 Cabeça chata philips cod. 792	Cavilha 6x30 Madeira estriada cod. 949
<b>(H)</b> 08x	<b>(I)</b> 08x	<b>(J)</b> 08x	<b>(K)</b> 04x	<b>(L)</b> 02x	<b>(M)</b> 02x	<b>(N)</b> 09x
						
Cavilha 8x20 Madeira estriada cod. 5225	Pino p/ Girofix Rosca soberba cod. 162	Tambor Ø12 cod. 183	Porca cilíndrica 12x8 Plástico cod. 163	Dobr curva 26mm Metálica cod. 131	Calço 12mm cod. 136	Chapa reta 2 furos Metálica 35x12x1 cod. 147
<b>(O)</b> 01x	<b>(P)</b> 01x	<b>(Q)</b> 01x	<b>(R)</b> 01x	<b>(S)</b> 12x	<b>(T)</b> 02x	<b>(U)</b> 04x
						
Puxador clean 100mm Alumínio Dourado cod. 847	Luminária Led 40x40 cod. 954	Passa fio 40mm	Passa fio 40mm	Bucha fixação Ø8 Plástico cod. 130	Sache de cola 10g cod. 166	Tapa furo 18mm
<b>(V)</b> 06x						
						
Tapa furo 18mm						

	Acessório	Qt.	Preto F/Noce M	cod.	Qt.	Off W/Nogueira R	cod.
Q	Passa fio plástico 40mm	1	Preto	907	1	Branco	159
R	Passa fio plástico 40mm	1	Preto	907	1	Preto	907
U	Tapa furo 18mm	4	Preto F	4622	4	Off W	901
V	Tapa furo 18mm	6	Noce M	4170	6	Nogueira R	3857