

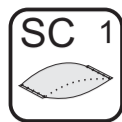

**PASSO 1**  
**PASO 1**  
**STEP 1**



Fazer a preparação de todas as peças, com os acessórios e as quantidades dos mesmos. **ATENÇÃO:** Antes de fixar as cavilhas A e as cavilhas escalonadas CC é necessário passar cola nos furos para ajudar a travar as peças. Evite excesso de cola, apenas uma pequena quantidade é suficiente para a fixação.

Hacer la preparación de todas las piezas, con los accesorios y las cantidades de los mismos. **PRECAUCIÓN:** antes de fijar las clavijas A e las clavijas escalonadas CC es necesario usar pegamento en los agujeros para ayudar a trabar las piezas. Evite pegamento demasiado pegamento. Sólo una pequeña cantidad es suficiente para la fijación.

Prepare all parts, accessories and quantities. **ATTENTION:** Before fastening the A Dowels and the CC Staggered Dowels, it is necessary to apply glue into the holes to help lock the parts. Avoid excess glue; only a small amount is enough for securing.

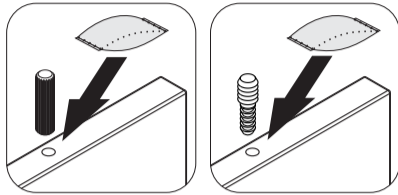

**PASSO 2**  
**PASO 2**  
**STEP 2**

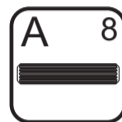

1 - Encaixe as cavilhas A (6x30mm) no topo das peças 3 e 5.

1 - Encaje las clavijas A (6x30mm) en el alto de las piezas 3 y 5.

1 - Fit in the (6x30mm) A pegs on the top of the pieces 3 & 5.

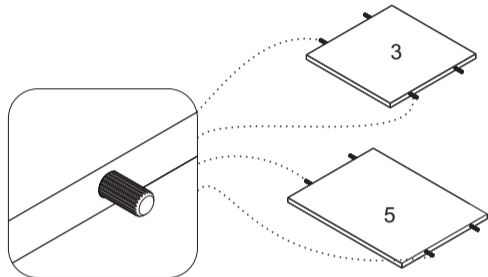

**PASSO 3**  
**PASO 3**  
**STEP 3**

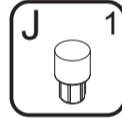
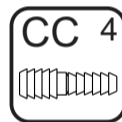

1 - Insira as cavilhas A (6x30mm) no topo e base das peças 2 e 4  
2 - Insira cavilhas escalonadas CC no topo das peças 2 e 4  
3 - Encaixe o batente da porta J na peça 4.

1 - Insertar las clavijas A (6x30mm) en la parte de cima de las piezas 2 y 4.  
2 - Insertar las clavijas bridadas CC en la parte de cima de las piezas 2 y 4.  
3 - Encaje el tope del puerta J en la pieza 4.

1 - Insert the A (6x30mm) dowels on top and base of parts 2 and 4.  
2 - Insert the CC flanged dowels on top of part 2 and 4.  
3 - Fit the J flap of door on part 4.

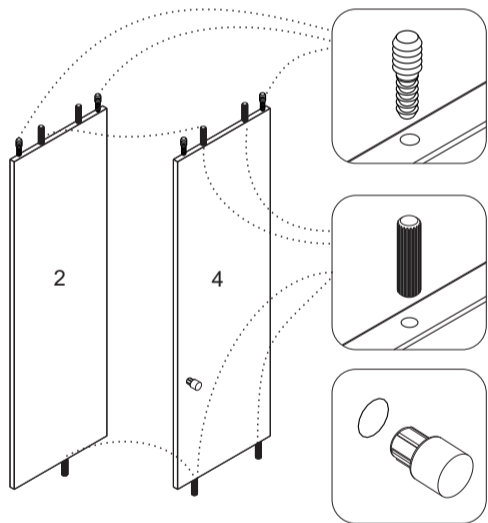

**PASSO 4**  
**PASO 4**  
**STEP 4**

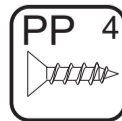
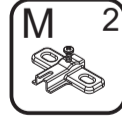
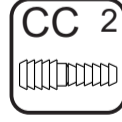
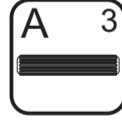

1 - Posicione 2 calços de dobradiças M alinhados aos furos superiores e inferiores da peça 6 e utilize os parafusos PP para fixá-los  
2 - Insira as cavilhas A (6x30mm) no topo e na base da peça 6  
3 - Insira cavilhas escalonadas CC no topo da peça 6

1 - Posicion 2 calzos del bisagra M alineados a los agujeros superiores e inferiores del pieza 6 y utilice los tornillos PP para fijarlos.  
2 - Insertar las clavijas A (6x30mm) en la parte de cima y en la base del pieza 6.  
3 - Insertar las clavijas bridadas CC en la parte de cima del parte 6

1 - Position 2 M wedges of hinges aligned to upper and lower holes of part 6 and use the PP screws for fix them.  
2 - Insert the A (6x30mm) dowels on top and base of part 6.  
3 - Insert CC flanged dowels on top of part 6

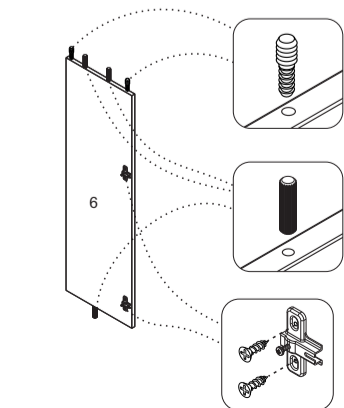

**PASSO 5**  
**PASO 5**  
**STEP 5**

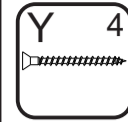

1 - Encaixe as peças 3 e 5 entre as peças 2, 4 e 6 e fixe-as com os parafusos Y (3,5x40mm)

1 - Encaje las piezas 3 y 5 entre las piezas 2, 4 y 6, y fijelas con los tornillos Y (3,5x40mm).

1. Fit in the pieces 3 and 5 between the pieces 2, 4 & 6, and secure them with (3,5x40mm) Y screws.

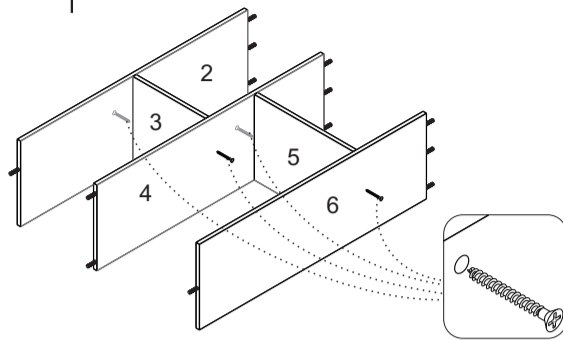

**PASSO 6**  
**PASO 6**  
**STEP 6**

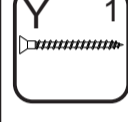

1 - Encaixe as peças 2, 4 e 6 na peça 1  
2 - Em seguida alinhe os pés PE na base 1 e utilize os parafusos PD (4,5x60mm) para fixar as peças em conjunto: pé + base + laterais.

1 - Encaje las piezas 2, 4 y 6 en la pieza 1.  
2 - Alinee las patas PE en la base 1 y utilice los tornillos PD (4,5x60mm) para fijar las piezas en conjunto: pata + base + laterales.

1. Fit in the pieces 2, 4 & 6 in the piece 1.  
2. Then, align the PE legs on the base 1, and use (4,5x60mm) PD screws to secure the pieces together: leg + base + sides.

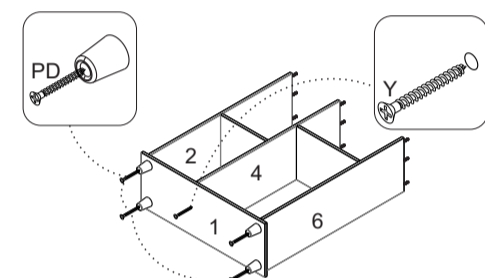

**PASSO 7**  
**PASO 7**  
**STEP 7**

1 - Encaixe a peça 7 nas peças 2, 4 e 6

1 - Encaje la pieza 7 en las piezas 2, 4 y 6.

1. Fit in the piece 7 in the pieces 2, 4 & 6.

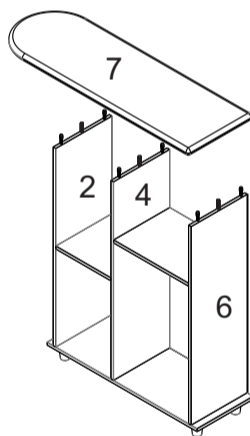

**PASSO 8**  
**PASO 8**  
**STEP 8**

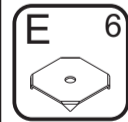
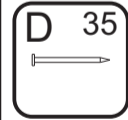

1 - **ATENÇÃO:** Antes de fixar os fundos verifique o esquadro do armário  
2 - Alinhe a peça 9 na lateral, base e tampo, fixe-a com os pregos D  
3 - Em seguida alinhe a outra peça 10 e fixe-a na lateral, base e tampo com os pregos D  
4 - Na junção entre as peças 9 e 10 utilize os pregos D em conjunto com os fixadores E.

1 - **ATENCIÓN:** Antes de fijar los fondos verifica el cuadrado del gabinete.  
2 - Alinear la pieza 9 en el lado, base y cubierta, fijela con los clavos D.  
3 - En seguida alinear la otra pieza 10 y fijela en la lado, base y en la cubierta con los clavos D.  
4 - En la unión de las piezas 9 y 10 usando los clavos D en conjunto con los fijadores E.

1 - **ATTENTION:** Before fix the bottoms check the square cabinet.  
2 - Align the part 9 on side, base and top, fix them with D nails.  
3 - Then align other part 10 and fix on side, base and top with D nails.  
4 - On the junction between the parts 9 and 10 use D nails on set with the E fasteners.

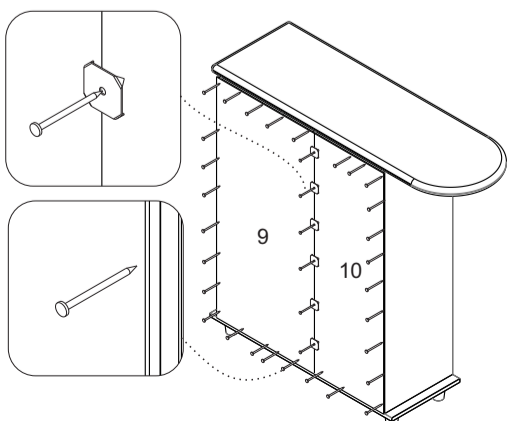

**PASSO 9**  
**PASO 9**  
**STEP 9**

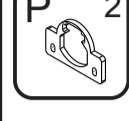
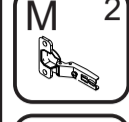
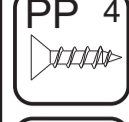

1 - Encaixe as dobradiças M na porta 8 e fixe-as com os parafusos X (4x12mm)

1 - Encaje las bisagras M en la puerta 8 y fijelas con los tornillos X (4x12mm).

Place the M hinges on the door 8, and secure them with (4x12mm) X screws.

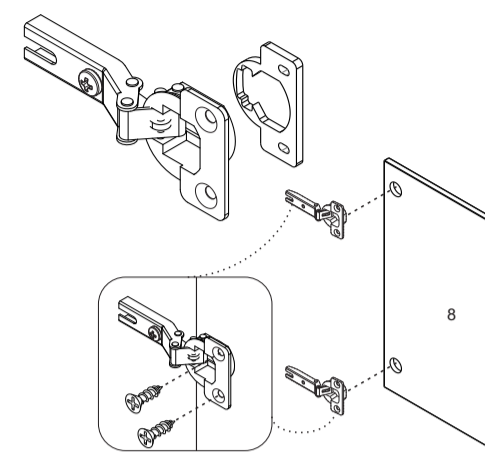

**PASSO 10**  
**PASO 10**  
**STEP 10**

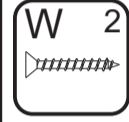

1 - Alinhe os puxadores S nos furos da porta 8 e fixe-os com os parafusos W (3,5x25mm)

1 - Alinee las manijas S en los agujeros de la puerta 8 y fijelas con los tornillos W (3,5x25mm).

1 - Align the S handles on the holes of door 8 and fix it with W (3,5x25mm)

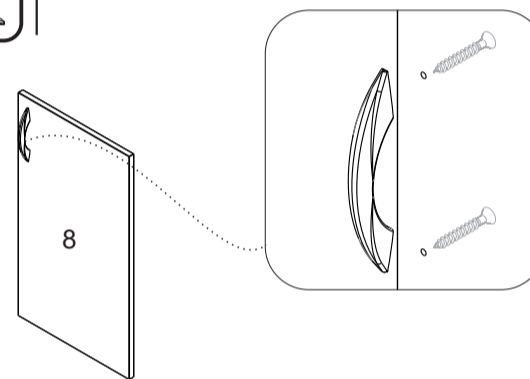

**PASSO 11**  
**PASO 11**  
**STEP 11**

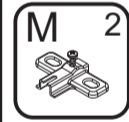

1 - Para montar a porta, encaixe as dobradiças M nos calços M travando-a no parafuso indicado com o número 1 abaixo:

1 - Alinee el porta-plancha SF en la lateral 6 y fijelo con los tornillos X (4x12mm).

1. Align the SF Iron Rest to the side 6, and secure it with (4x12mm) X screws.

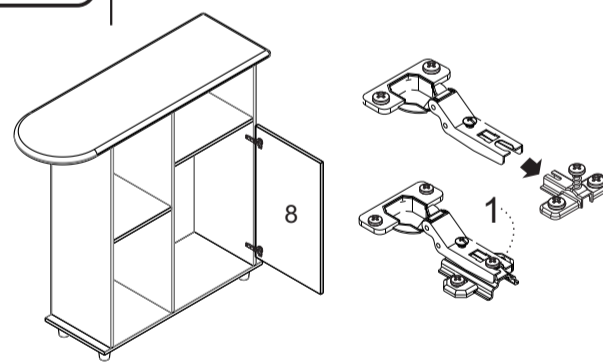

**PASSO 12**  
**PASO 12**  
**STEP 12**

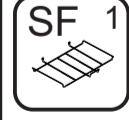
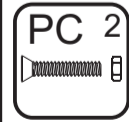

1 - Alinhe o porta ferro SF na lateral 6 e fixe-o com os parafusos X (4x12mm)

1 - Alinee el porta-plancha SF en la lateral 6 y fijelo con los tornillos X (4x12mm).

1. Align the SF Iron Rest to the side 6, and secure it with (4x12mm) X screws.

